



PHARMACY SYSTEM TECHNICAL CATALOGUE



UNITED KINGDOM

At CAEM we design and manufacture tailored pharmacy and dispensary solutions that transform our clients' working spaces, maximising both storage and efficiency.

Our experienced design team, comprehensive manufacturing capability, and huge network of trusted partners have been delivering value to UK clients since 1989.

CAEM's teams are environmentally focused and aiming towards net zero. We believe that every decision we make should consider the environment, and ensure the reduction of our environmental impact.



Magrini (UK) Ltd - CAEM UK
Unit 3 - Jamage Industrial Estate
Talke Pits - Stoke-On-Trent - ST7 1XW - UK

T. 01782 794500
information@caem.co.uk

WHY USE D25?

1

THE COMPLETE PHARMACY FURNITURE RANGE

2

HIGH DENSITY MEDICINES STORAGE FOR EFFICIENT OPERATIONS

3

MODULAR DRAWERS - DURABLE, ADJUSTABLE, ADAPTABLE

CAEM AT A GLANCE

- GLOBALLY RECOGNISED
- DESIGN AND PROTOTYPING
- ADVANCED MANUFACTURING
- ENVIRONMENTALLY FOCUSED
- FULLY MODULAR FURNITURE SOLUTIONS

WWW.CAEM.CO.UK

MAXIMISE PHARMACY STORAGE



With D25 your pharmacy will achieve higher returns.

Increasing the density of drugs storage will allow for a bigger retail area that will deliver extra sales.

D25 is fully adaptable and future proof: all types of drawers can be relocated at any time on any of the units, so the dispensary can be re-organised at any future time.

Adopting D25 is a long term investment thanks to its high precision and durable metal build.

		Storage Capacity				Retail Sales	
		Dispensary Floorspace	Shelves or Drawers	One Shelf or Drawer	Total Storage	Retail Shop Facings	
		sq ft	number	sq ft	sq ft	unit	
BASIC	A TRADITIONAL PHARMACY	24	270	0,2	0%	24	0%
MEDISTOCK	DISPENSARY ADOPTS D25 - MORE STORAGE	24	162	0,2	46%	24	0%
MEDIBASIC	SAME STORAGE - MORE SALES	18	108	0,5	-2%	30	25%
MEDISALES	LESS STORAGE - MUCH MORE SALES	10	54	0,5	-52%	36	50%

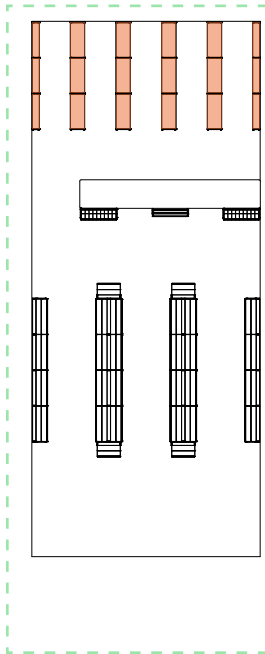

BASIC
An example of a dispensary built with any type of storage shelving.

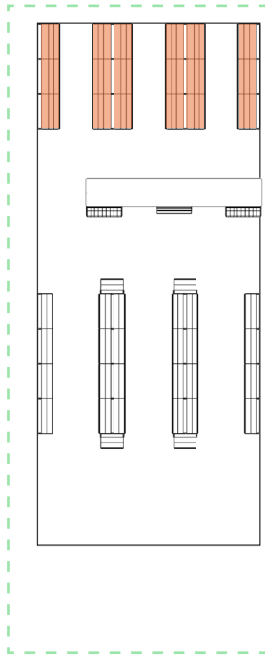

MEDISTOCK
Changing from shelving to D25 drawers, the same dispensary will hold nearly 50% more medicines, allowing for more volume.

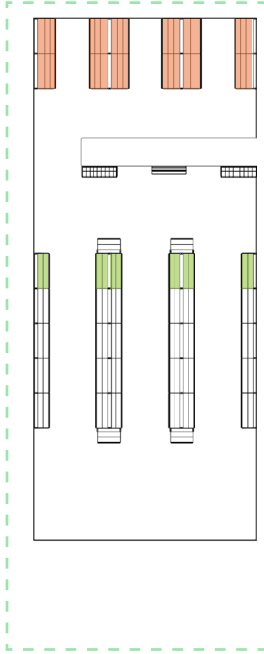

MEDIBASIC
The dispensary floor space could be shrunk and still be capable of the same storage. This would increase retail sales floor area, and sales, by 25%.

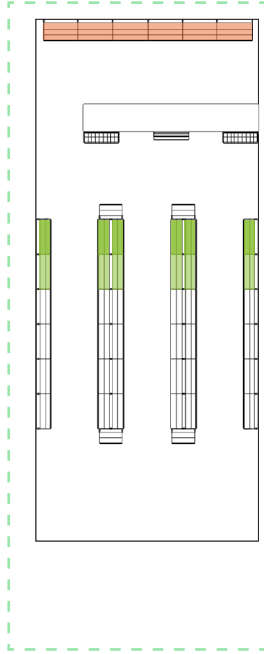

MEDISALES
Thanks to its high density performance, D25 can be used to reduce the dispensary area even further, to boost retail merchandising and sales by 50%.

WELCOME TO D25



D25: THE COMPLETE PHARMACY FURNITURE RANGE



D25: MODULAR, DURABLE, ADAPTABLE



D25, WALL AND CENTRE UNITS



D25, THE WIDEST RANGE



D25 - PRODUCT MAP

WIDTH

66cm, 80cm, 100cm

DEPTH

30cm, 40cm , 50cm

COLOUR

ANTIBACTERIAL CLINICAL WHITE - TEXTURED FINISH
RAL 9003 - code: LA90

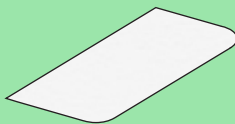

THE WORKTOP

HEIGHT

95cm

WALL

57cm deep

CENTRE

57cm + 5cm deep

Worktops are a solid 25mm thick laminate that lays on a modular yet sturdy holding bracket. It leaves the entire area below completely free to be organised to your preference.

COLOUR

Many Options, Silver Recommended

Wide choice of colours - 25mm thick with ABS edge



SPECIAL WORKTOP

D 57 + 10



TIMBER SIDES

WIDE CHOICE OF COLOURS - 25MM THICK WITH ABS EDGE



FLOORDRAWER

WIDTH

66cm, 80cm, 100cm

DEPTH

40cm, 50cm

HEIGHT

23cm, 43cm

The Floordrawer is a high volume drawer that sits under the unit. It can be removed to allow for deep cleaning.

Floordrawers are available in two heights: 23cm and 43cm.

Internal organisation is extremely efficient thanks to back-to-front and side-to-side dividers.



23 IN



23 OUT



43 IN



43 OUT

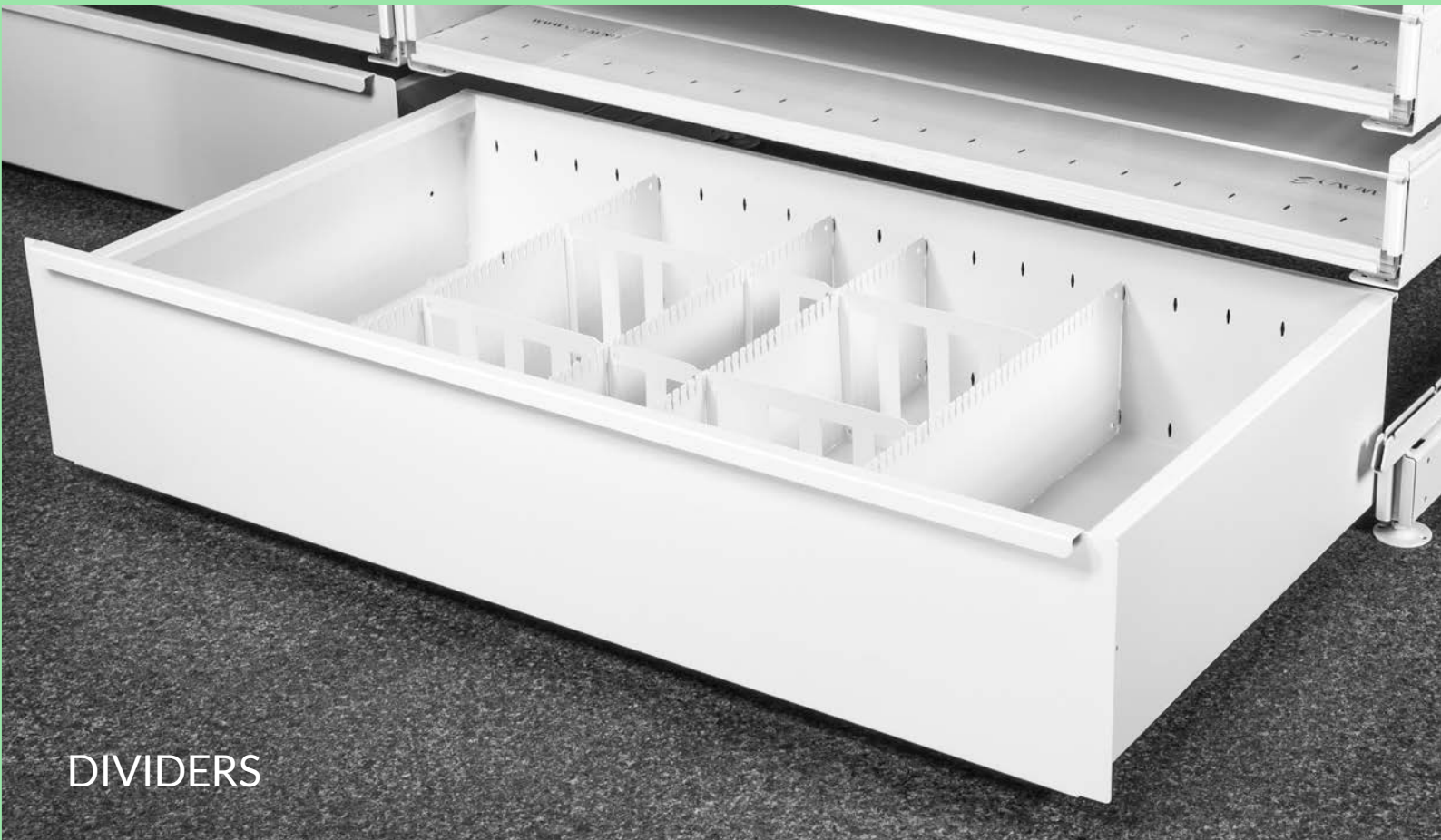

DIVIDERS



WHEEL



WHEEL



WHEEL



WHEEL

READYDRAWER

WIDTH

66cm, 80cm, 100cm

DEPTH

40cm, 50cm

HEIGHT

17cm, 27cm

Readydrawers connect to the D25 structure at any desired height.
The very same Readydrawer can be installed horizontally or inclined 15°.
A full width handle under the drawers guarantees maximum ease of use.
Readydrawers have two automatic lock positions: when closed and when fully opened.
Organising these pull-out shelves is extremely easy and flexible: back-to-front and side-to-side
dividers are available in various sizes.



READYDRAWER 27 CLOSED

Readydrawer risers include a finger hole for ease of use. These should be ordered separately.



READYDRAWER 27 OPEN

By using a H=27cm riser, Readydrawer perfectly integrates under the worktop. It is also intended for prescriptions storage.



READYDRAWER 17 CLOSED

The risers come in a frosted white finish to cover the content of readyscripts, as required by legislation.



READYDRAWER 17 OPEN

By using a H=17cm riser, Readydrawer is perfect for high capacity medicine storage.

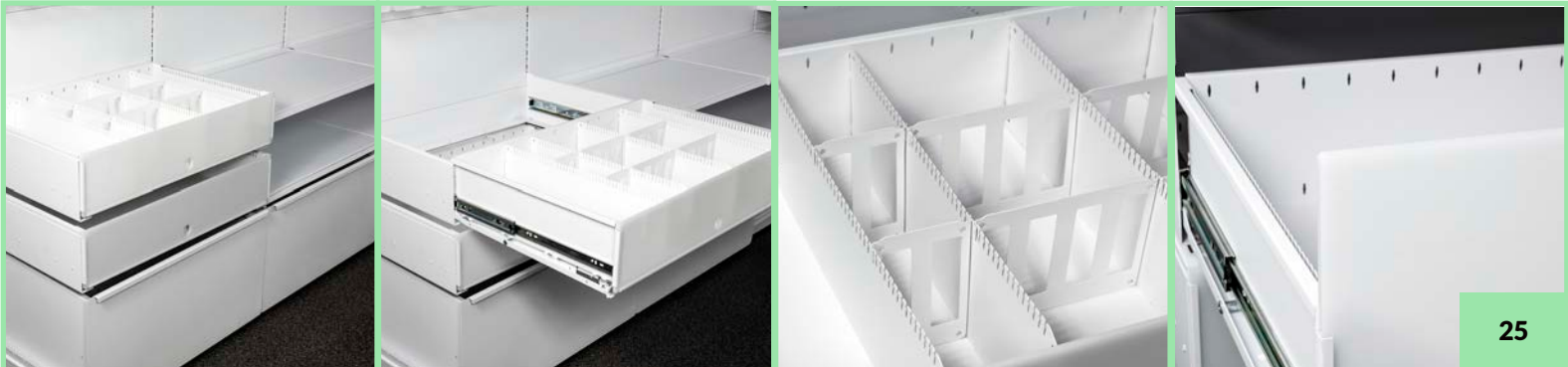

READYDRAWER COMBINATIONS

UNDER THE WORKTOP



READYDRAWER COMBINATIONS

IN FULL HEIGHT STORAGE UNITS



43+7*17

23+8*17

BASE+8*17

43+5*27

23+5*27

5*27



MEDIDRAWER

WIDTH

66cm, 80cm, 100cm

DEPTH

30cm, 40cm, 50cm

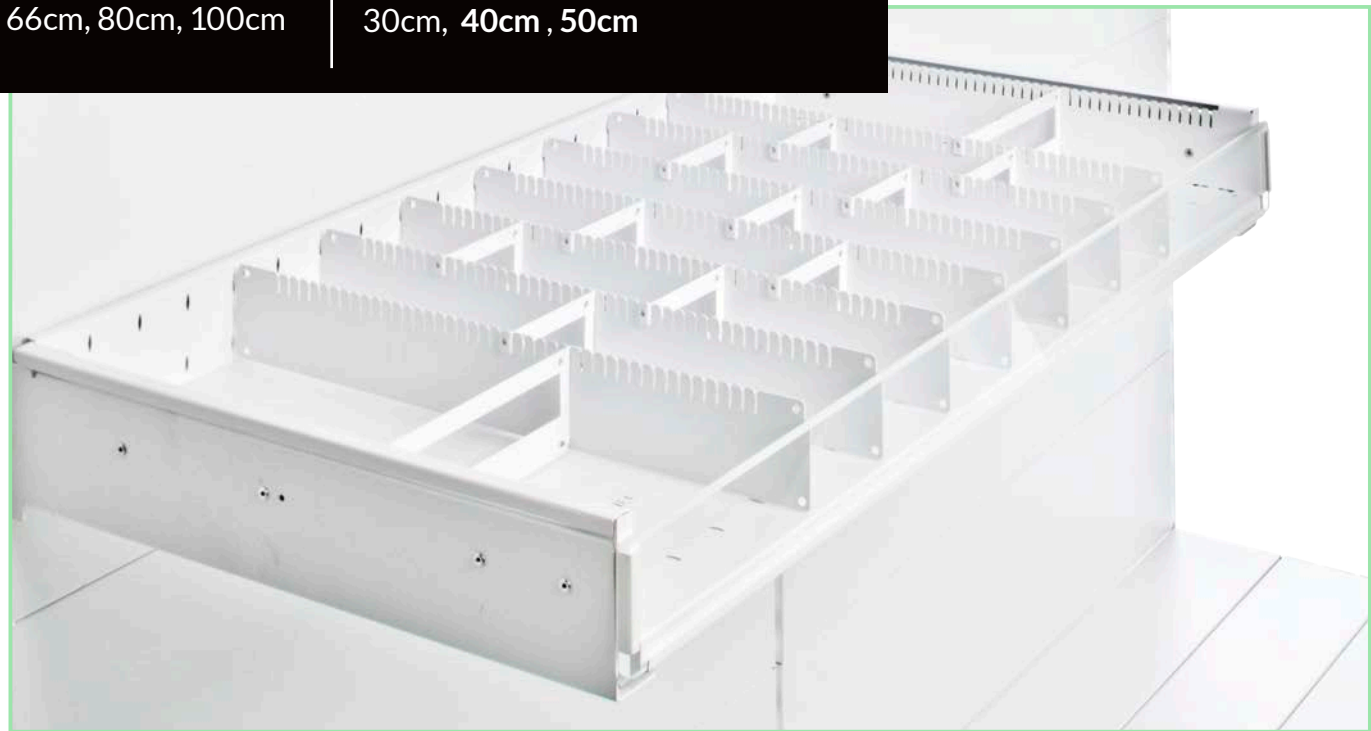

Medidrawer is the pull out shelf for high density medicines storage. It is 8cm high and comes with an integrated transparent front riser. The riser has a rounded top for comfortable use. Organising content within Medidrawers is extremely easy thanks to a range of back-to-front and side-to-side dividers.



Medidrawers have two automatic lock positions: when closed and when fully open. A handle underneath spans the full width, allowing for easy unlocking. The runners are tested to 50,000 opening cycles at 15kg of load.



MEDIDRAWER - CONFIGURATIONS

UNDER THE WORKTOP

WIDTH

66cm, 80cm, 100cm

DEPTH

30cm, 40cm , 50cm



43+8+17



43+8+27



43+8+8+8



BASE+8+8+8+27



BASE+8+8+8+17



BASE+5*8



23+8+8+8+27



SHELF
23+8+8+8+17



SHELF 23+4*8

MEDIDRAWER

ABOVE THE WORKTOP

WIDTH

66cm, 80cm, 100cm

DEPTH

30cm, 40cm, 50cm

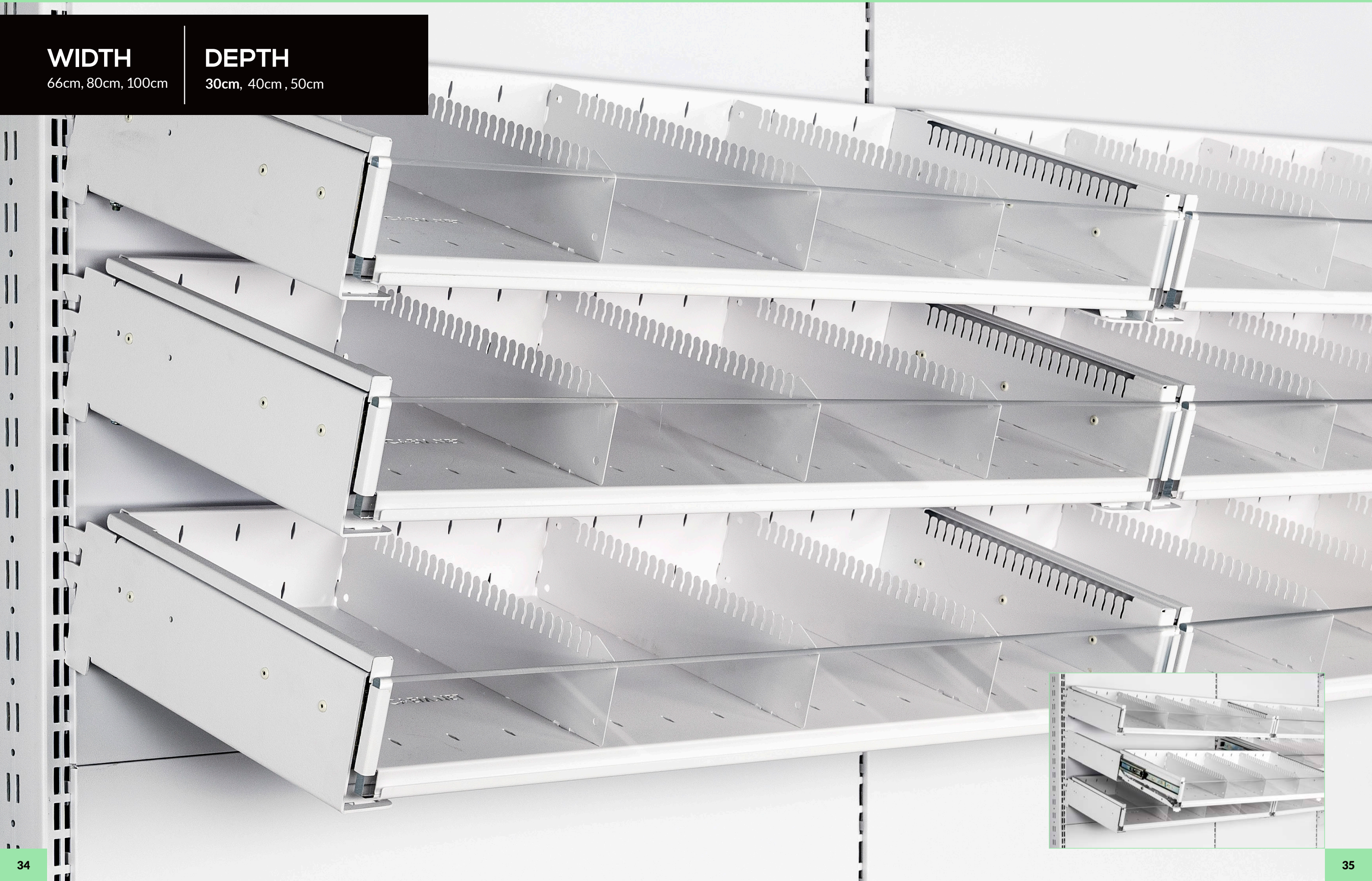

MEDIDRAWER
FOR HIGH DENSITY STORAGE

WIDTH

66cm, 80cm, 100cm

DEPTH

30cm, 40cm, 50cm



MEDIDRAWER is the stocking solution for drugs: it works as a pull-out shelf, includes flexible and space saving dividers and a transparent front. The use of MEDIDRAWERS in the dispensary area of pharmacies and within the medicine stocks in hospitals delivers sensational space savings, with the consequence of more free space for stock or for other purposes.



MEDIDRAWER

FOR HIGH DENSITY STORAGE



The D25 structure in conjunction with MEDIDRAWER deliver extreme flexibility: storage can be organised with all trays horizontal, inclined or partly horizontal and partly inclined.

The storage units remain fully adaptable to future needs: the MEDIDRAWERS can be repositioned across the wall and the centre room units at any time.

We recommend 9 MEDIDRAWERS per unit, to reach a good combination of safe ergonomics, efficient use of floorspace and enough vertical stock space in each drawer.



MEDIDRAWER

FOR HIGH DENSITY STORAGE

During the design stage, the installation process or at any time during its use, spacing between MEDIDRAWERS can be adjusted with ease.



Drawer spacing is normally calculated to leave 4cm/1½" free. This is to allow access to, and operation of the unlocking bar under the units.



MEDIDRAWER

FOR HIGH DENSITY STORAGE



Back-to-front dividers can be placed and adjusted easily across the drawer at 48mm/2 inch intervals. Side-to-side dividers are designed with a window to allow pharmacists see medicines through them. These can be placed between the back-to-front dividers, with secure mounting points provided at 10mm/½ inch intervals.

Compartments can be created and adjusted easily at any time in infinite combinations.

Back-to-front dividers click into holes at the rear of the MEDIDRAWER and rotate down in the location pin.

Side-to-side dividers are the dividers from right to left: they slide into and between the back-to-front dividers.

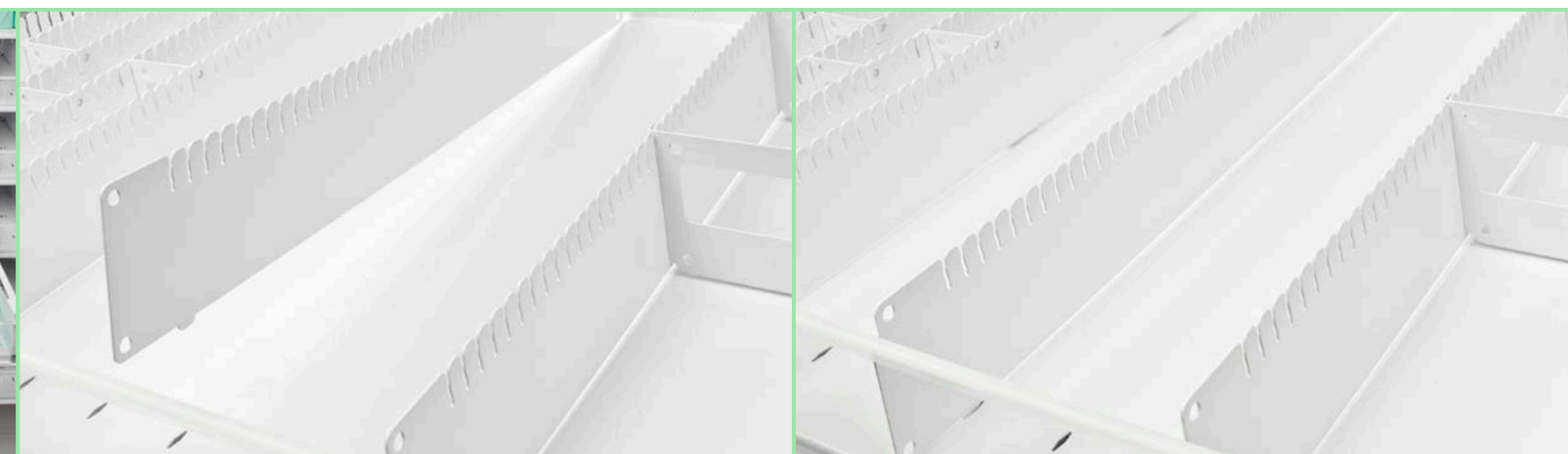

MEDIDRAWER

FOR HIGH DENSITY STORAGE



We recommend using our metallic play of letters that slot onto the fronts of both MEDIDRAWERS and READYDRAWERS.

Other indexing options are available, like these full-length transparent paper holders.

TRAYS

TRAYS SIZES

136X104X76
187X104X76

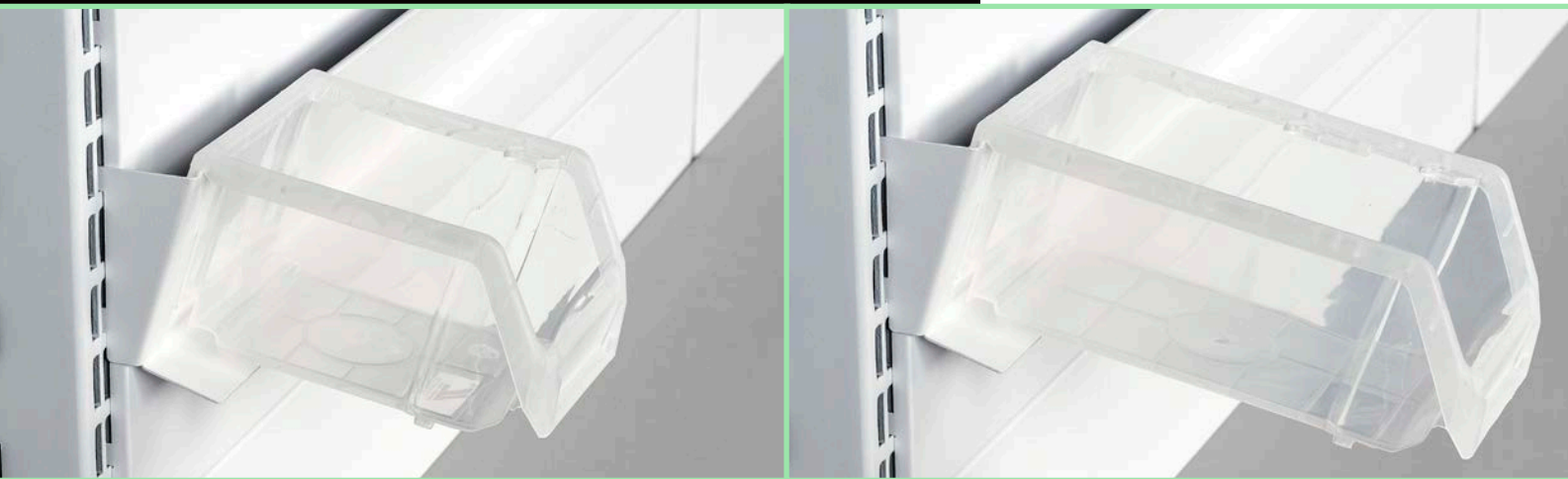

The BSN Trays are made with durable frosted transparent plastic.

They are extremely practical within the pharmacy operations: they can hang suspended on the bar, they can stack one on top of the other and, when not in use, they will nest one into the other to occupy less space.



BAR SUPPORTING TRAYS

66cm, 80cm, 100cm

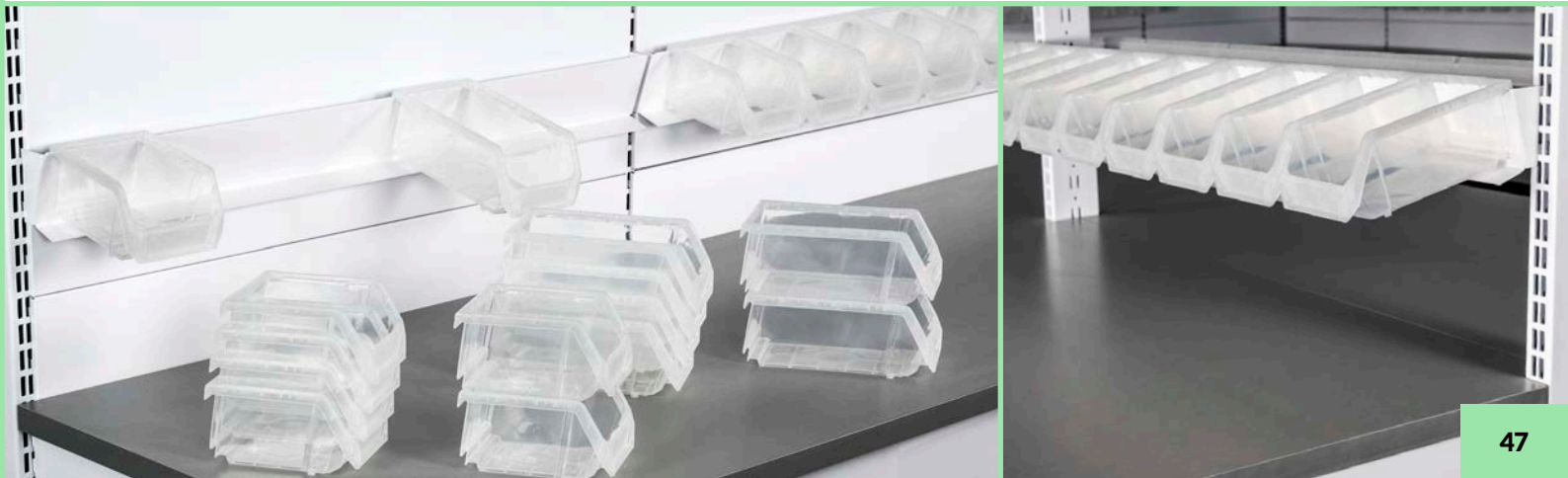
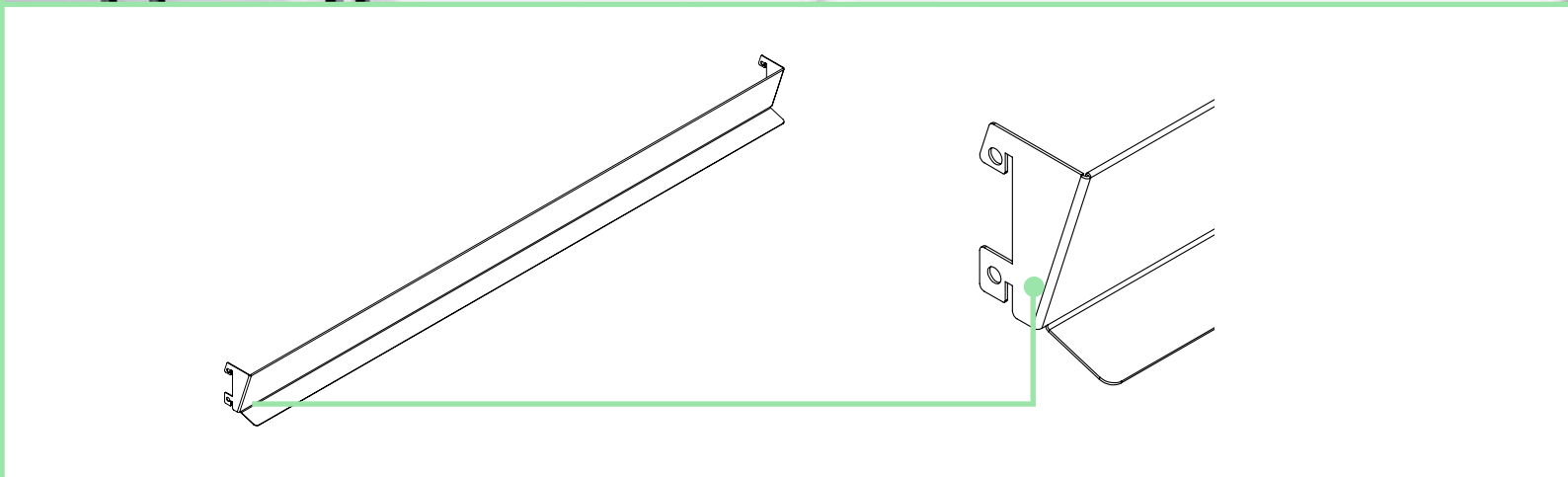

BEEHIVE SHELVES

WIDTH

66cm, 80cm, 100cm

DEPTH

30cm

HEIGHT

30cm



CREATE SECTIONED
SHELVING IN A FULLY
MODULAR WAY



SHELVING

WIDTH

66cm, 80cm, 100cm

DEPTH

30cm, 40cm, 50cm

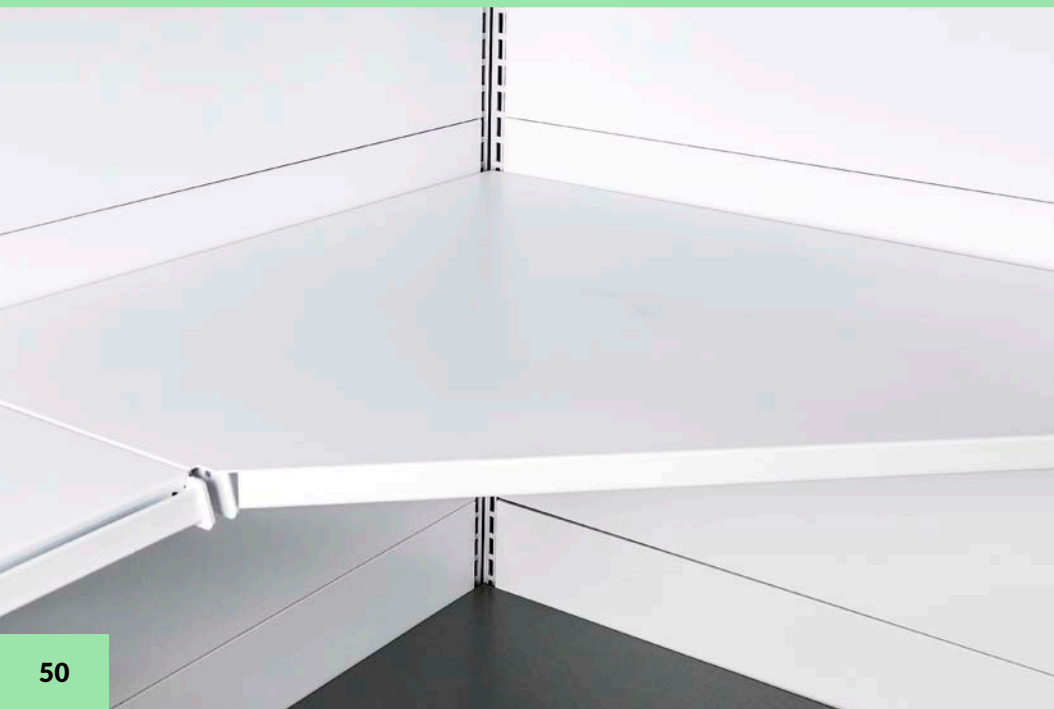

SHELF ORGANISERS

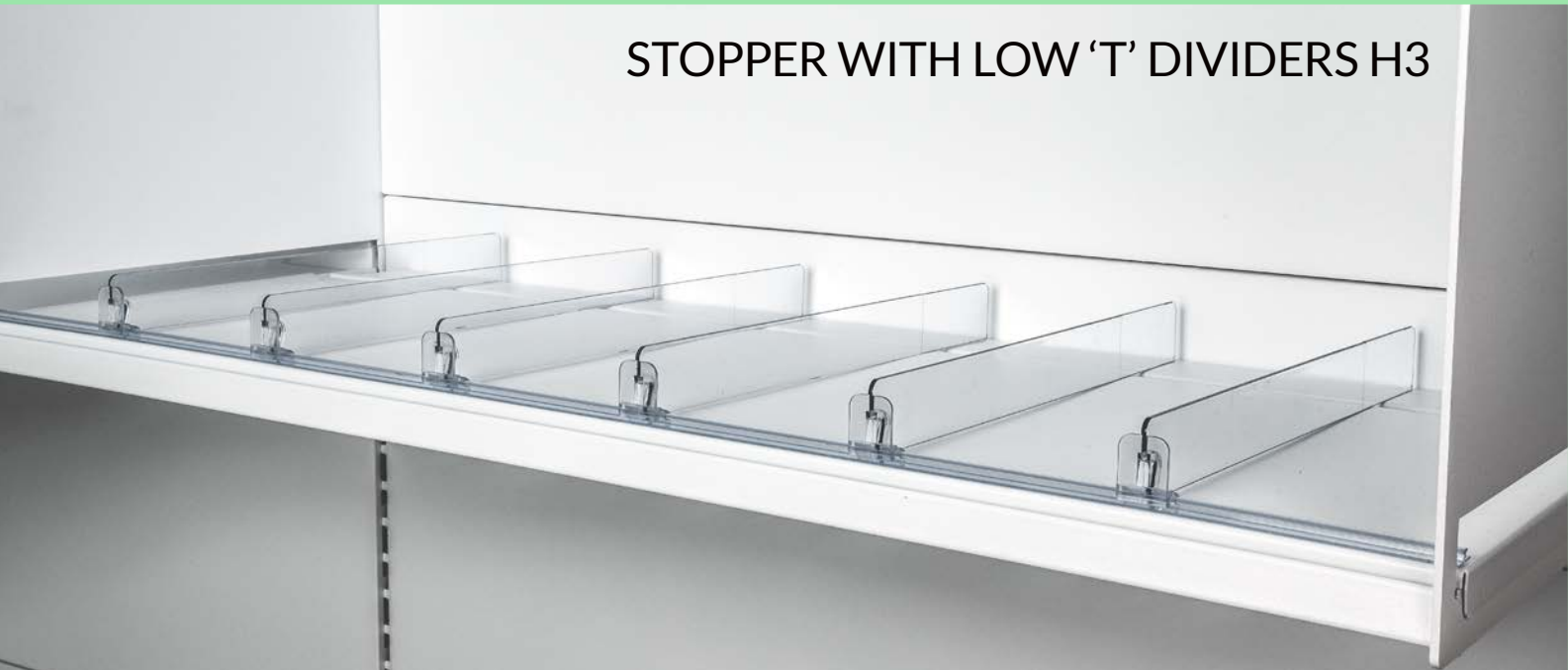

LIGHT SYSTEM

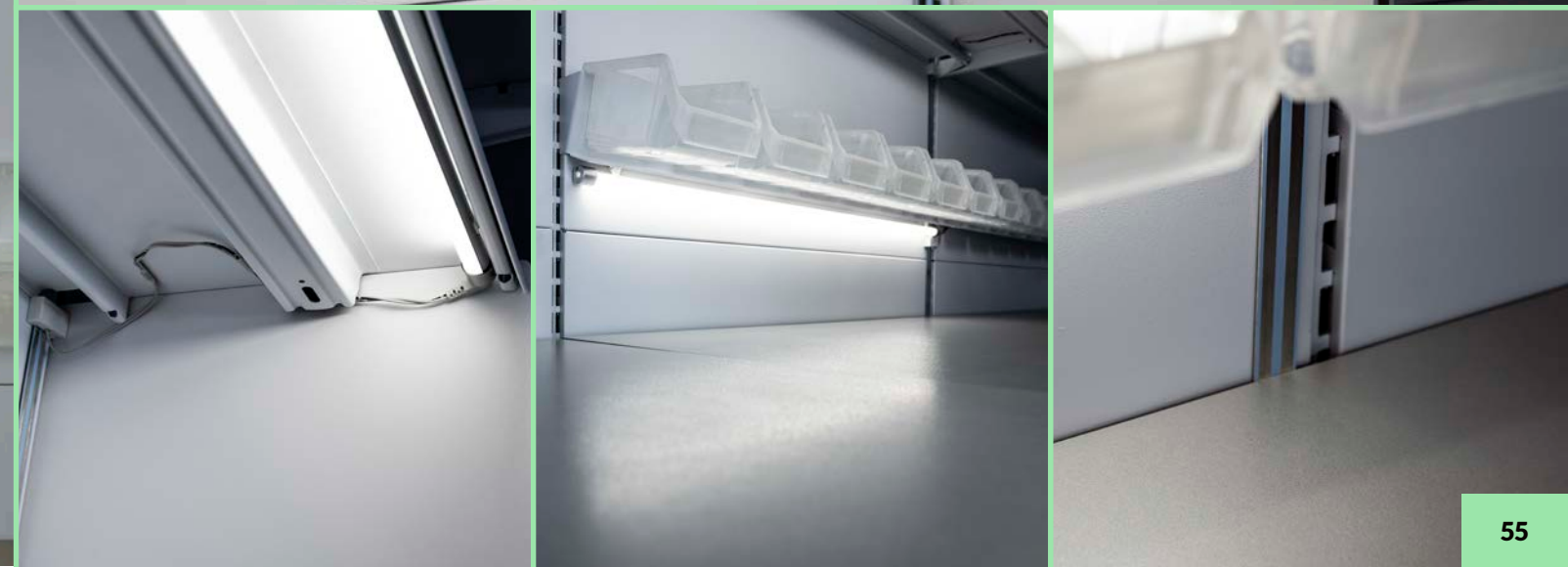

OPTIONAL ANTIMICROBIAL PROTECTION



KEEPING YOU SAFER WITH ANTIBACTERIAL COATINGS.

Micro-organisms, both good and bad are a fact of life and are all around us in the environment. As part of the CAEM commitment to hygiene the D25 solution uses a specially developed range of antimicrobial coatings. These powder coatings are not only aesthetically beautiful and hard wearing, they contain Silver ions that help to inhibit the growth of microbes on the coated surface. These coatings are designed to provide protection over an extended period and add a further layer of peace of mind for pharmacies and dispensaries.

KEY FEATURES:

- USES POWDER COATING THAT IS MORE RESISTANT TO KNOCKS, CHIPS AND SCRATCHES AND IS SIGNIFICANTLY MORE DURABLE THAN STANDARD PAINT.
- SIGNIFICANTLY REDUCES MICROBIAL ACTIVITY.
- RETAINS ITS ANTI-MICROBIAL PROPERTIES FOR AN EXTENDED TIME.
- EFFECTIVE AGAINST A CROSS SECTION OF BACTERIA AND FUNGI.
- PROTECTS AGAINST THE SPREAD OF MICRO-ORGANISMS.
- OPTICALLY NEUTRAL.
- ENVIRONMENTALLY FRIENDLY.

WHY AN ANTIMICROBIAL FINISH?

Our environment is full of microbes, both good and bad (bacteria, archaea, fungi, protozoa, algae, and viruses). Pharmacies are businesses that are exposed to high levels of these, brought into the space by serving the general public, and often ill and potentially contagious individuals. The risk of cross contamination, either from these individuals or from in house teams is quite high. Consistent hygiene is paramount within a pharmacy or dispensary environment, and though pharmacists will have thorough cleaning routines, anything that can help further with this can't be a bad thing. This is why CAEM D25 has a specialist coating that aids in the eradication of these potentially bad micro-organisms before there is a chance of cross contamination.

HOW DOES IT WORK?

The powder coatings that are applied to the CAEM D25 solutions use specialised recipes that slowly release Silver ions in the presence of moisture. These Silver ions interfere with the cell membranes to inhibit the respiration and growth of many types of micro-organisms. Silver ions are environmentally sustainable and further, Silver offers this protection without high toxicity to people or animals.

HOW EFFECTIVE IS THE COATING?

The effectiveness of the CAEM's coating against multi-resistant germs has been tested in accordance with JIS Z 2801-2010, corresponding to the international standard ISO 22196:2007. Test reports show reduction of Staphylococcus aureus and Escherichia coli bacterial activity superior to 99.9% on a coated protected surface.

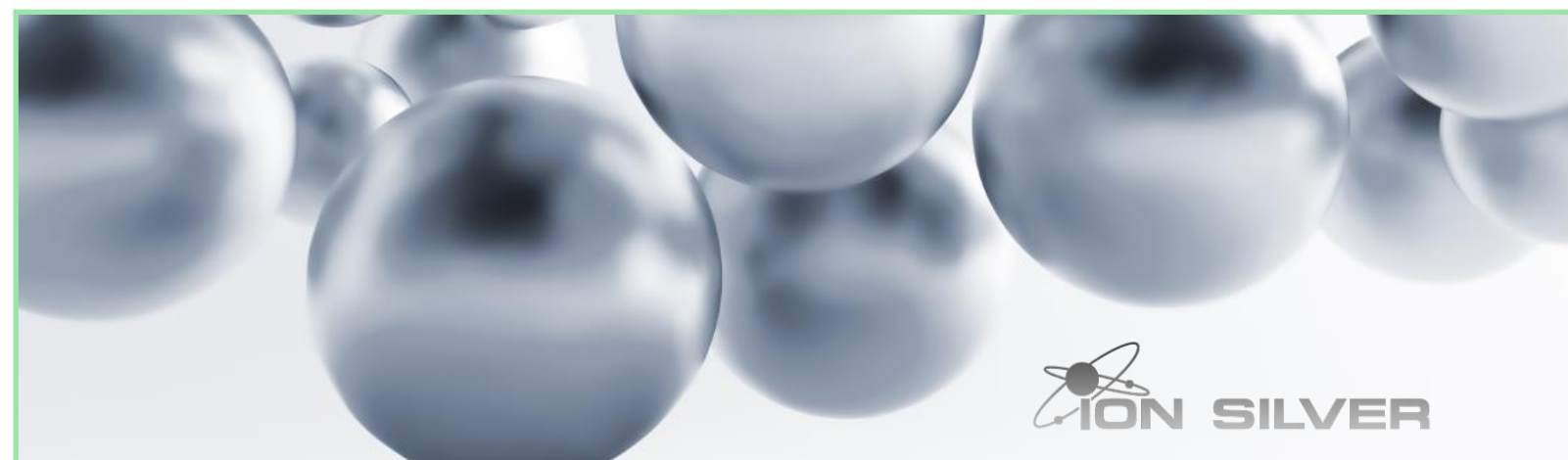

*Disclaimer. The use of the antimicrobial coating is not a substitute for a good hygiene routine, it is simply an additional layer of protection. D25 units must be kept thoroughly clean to reduce the chance of cross contamination. Please ensure that the correct cleaning solutions are used to avoid damage to the surface. Lab tests for antimicrobial activity and efficacy were carried out on the powder coated surface, exposed to the attack of the most common bacteria, Gram-positive and Gram-negative.

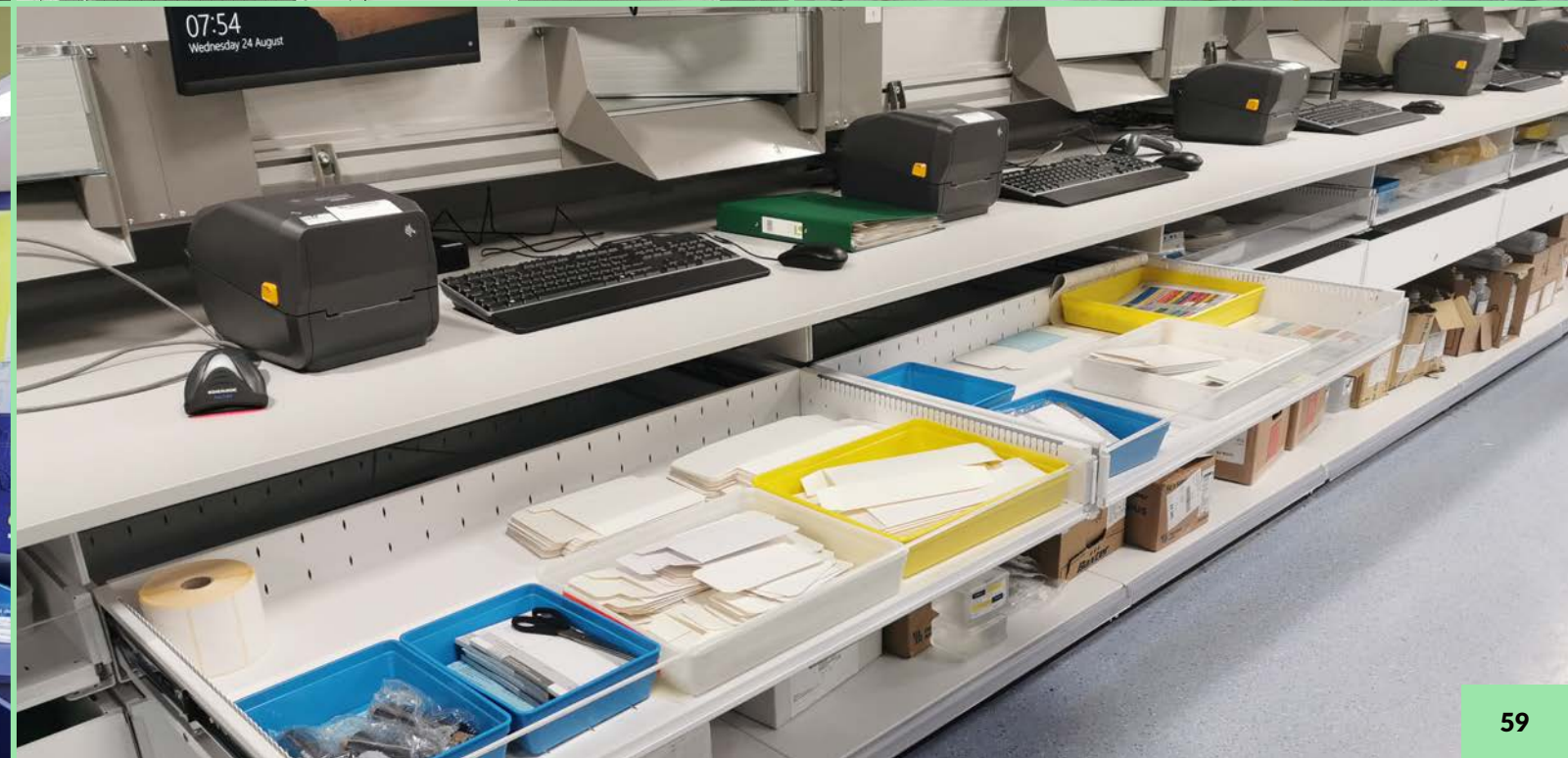

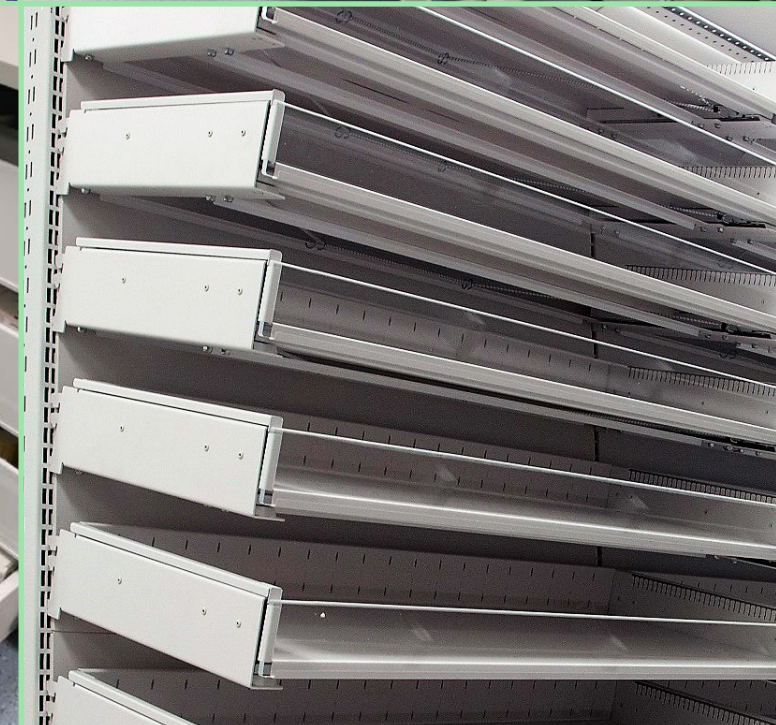

D25 - PROFILES LIBRARY

D25
H=223 L=50

WALL UNITS
ABOVE THE TOP
CONFIGURATIONS

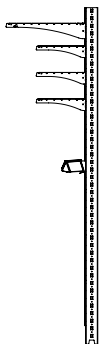

WA1

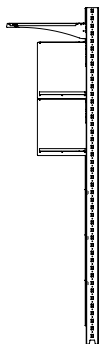

WA2

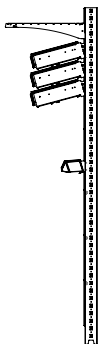

WA3

D25
H223 L=50

WALL UNITS
BELOW THE TOP
CONFIGURATIONS

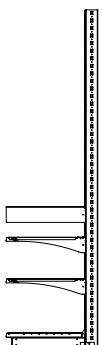

WB1

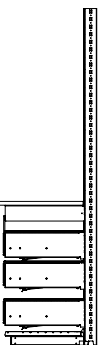

WB2

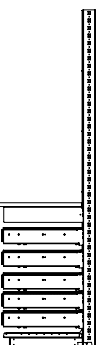

WB3

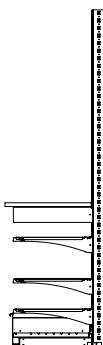

WB4

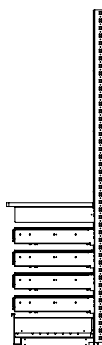

WB5

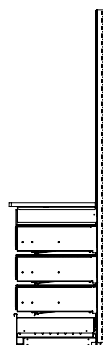

WB6

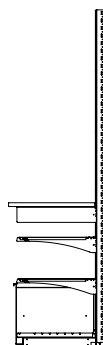

WB7

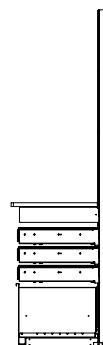

WB8

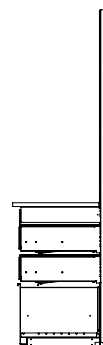

WB9

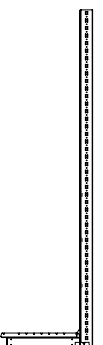

WBE

D25
H=143 L=50+50

CENTRE UNITS
ABOVE THE TOP
CONFIGURATIONS

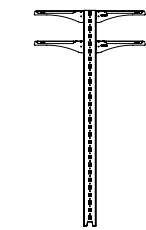

GA1

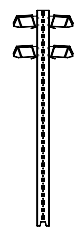

GA2

D25
H=143 L=50+50

CENTRE UNITS
BELOW THE TOP
CONFIGURATIONS

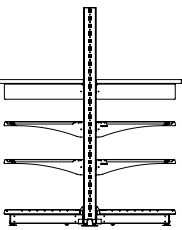

GB1

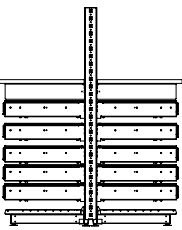

GB2

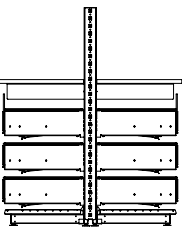

GB3

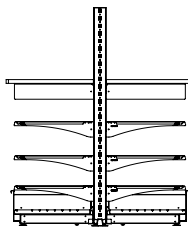

GB4

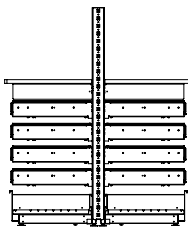

GB5

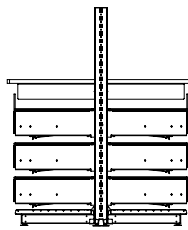

GB6

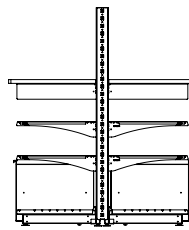

GB7

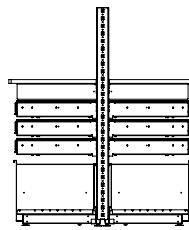

GB8

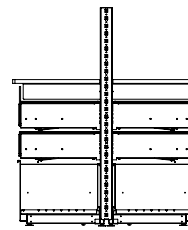

GB9

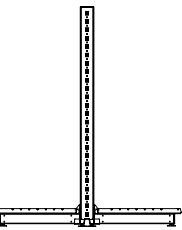

GBE

D25
H=95 L=50+50

CENTRE ROOM COUNTER
FULL CONFIGURATIONS

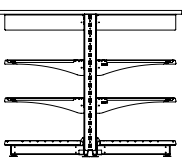

CB1

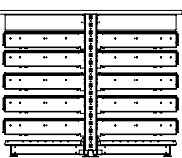

CB2

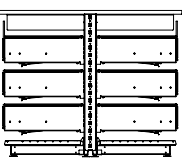

CB3

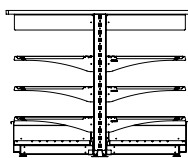

CB4

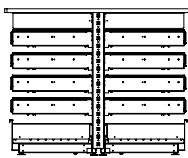

CB5

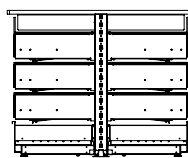

CB6

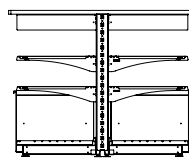

CB7

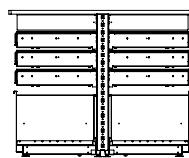

CB8

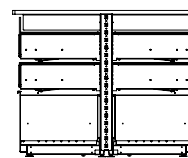

CB9

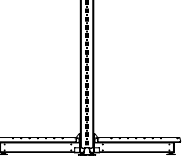

CBE

D25 - PROFILES LIBRARY

D25

WALL STORAGE
H=223
L= 30, 40, 50

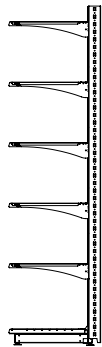

WS1

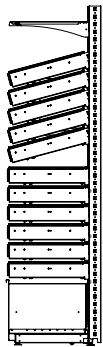

WS2

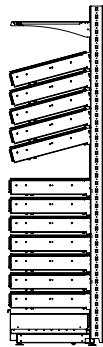

WS3

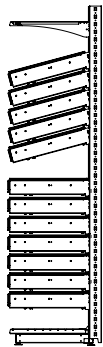

WS4

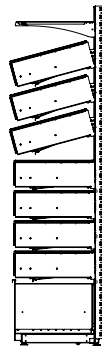

WS5

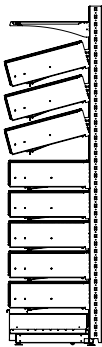

WS6

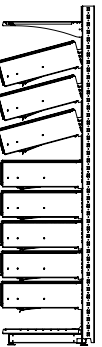

WS7

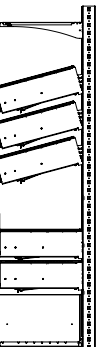

WS8

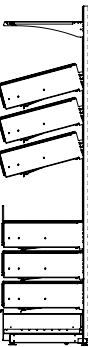

WS9

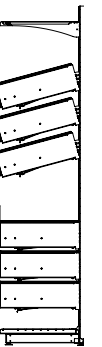

WS10

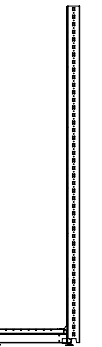

WSE

D25

CENTRE ROOM STORAGE
H=223
L= 30, 40, 50

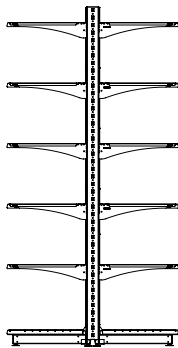

GS1

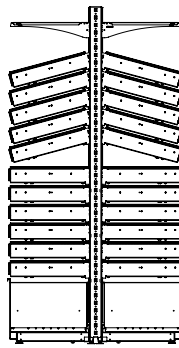

GS2

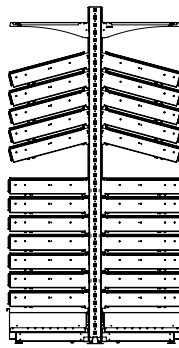

GS3

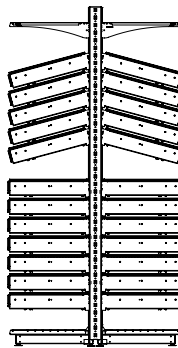

GS4

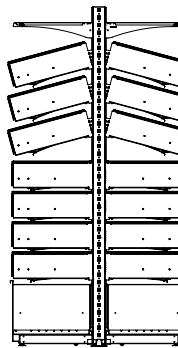

GS5

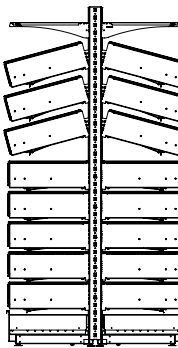

GS6

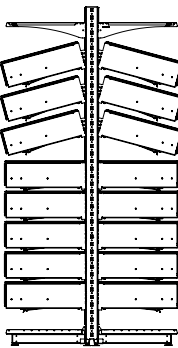

GS7

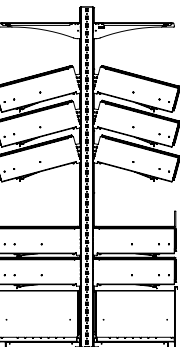

GS8

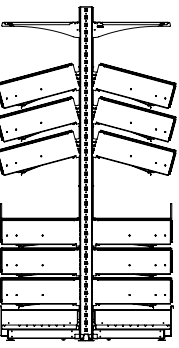

GS9

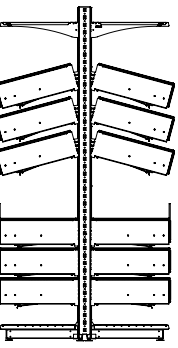

GS10

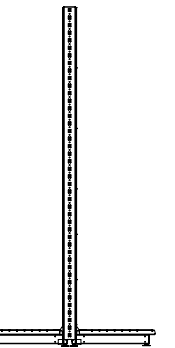

WSE

- * The drawings refer to L=50cm
- * MEDIDRAWERS are available in L=30cm, 40cm, 50cm
- * READYDRAWERS are available in L=40cm, 50cm
- * FLOORDRAWERS are available in L=40cm, 50cm

TECHNICAL CATALOGUE



WALL AND CENTRAL UNITS

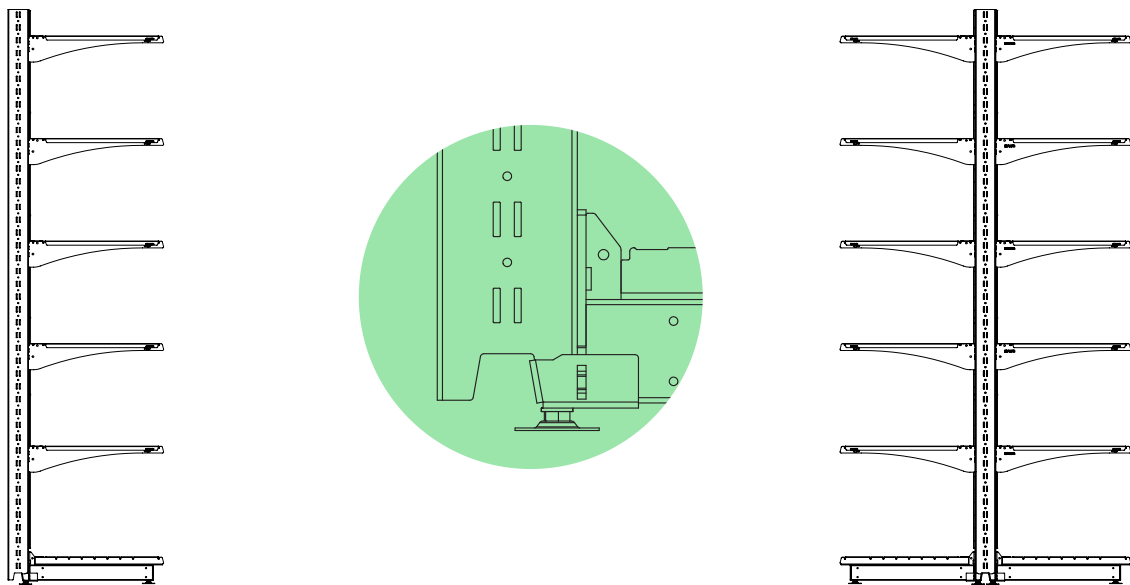

WALL AND CENTRAL UNIT STRUCTURE

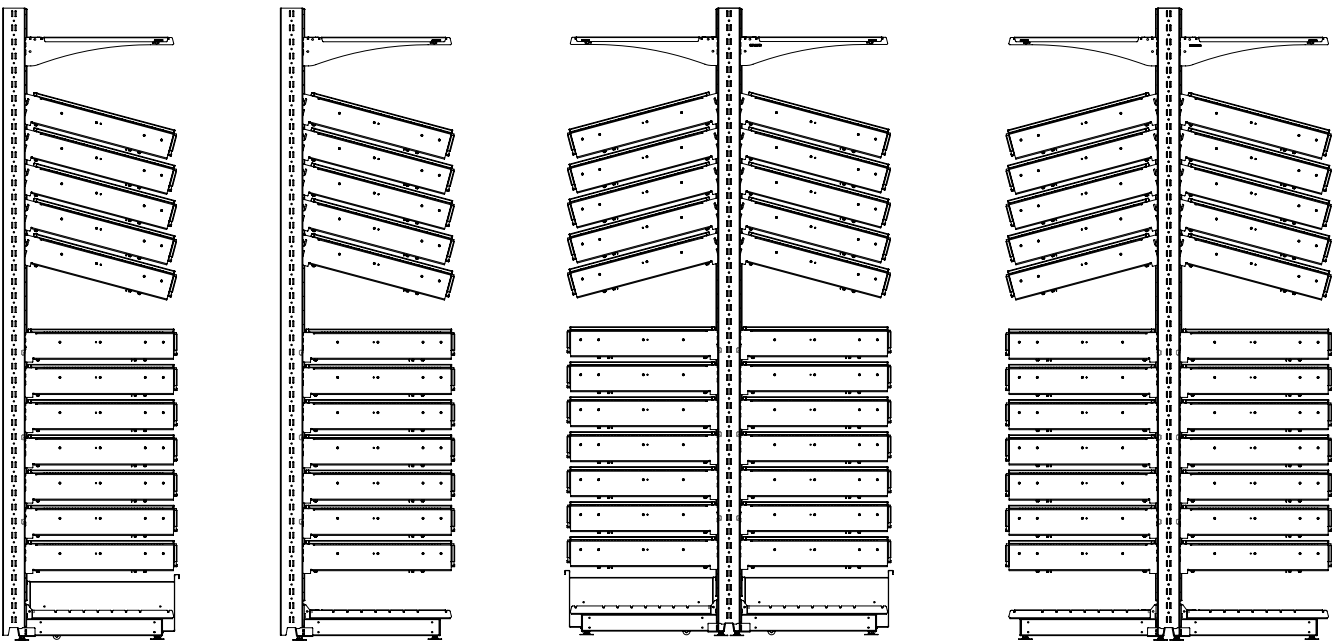

WALL AND CENTRAL UNIT EXAMPLES

UNIT WIDTHS

66 AAP
CORNERS

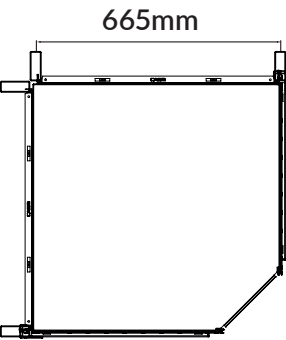

66

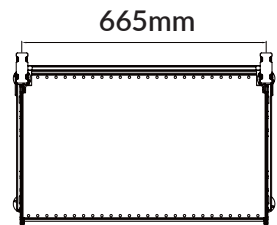

80

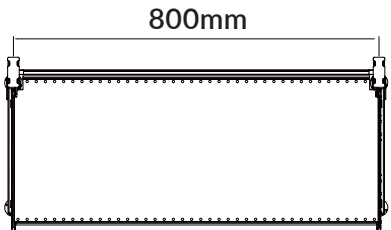

100

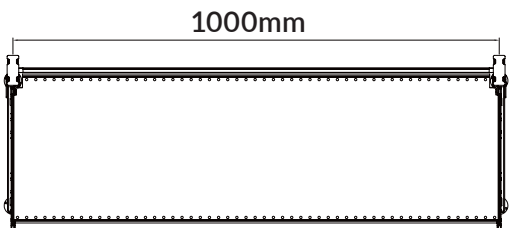

*ADD +30MM AT THE END OF THE RUN

UPRIGHTS

Upright available in 80x30mm sections to cater for all loading needs, with 25mm paced slots for brackets and frontal back panels and 50mm paced side-slots for central back panels

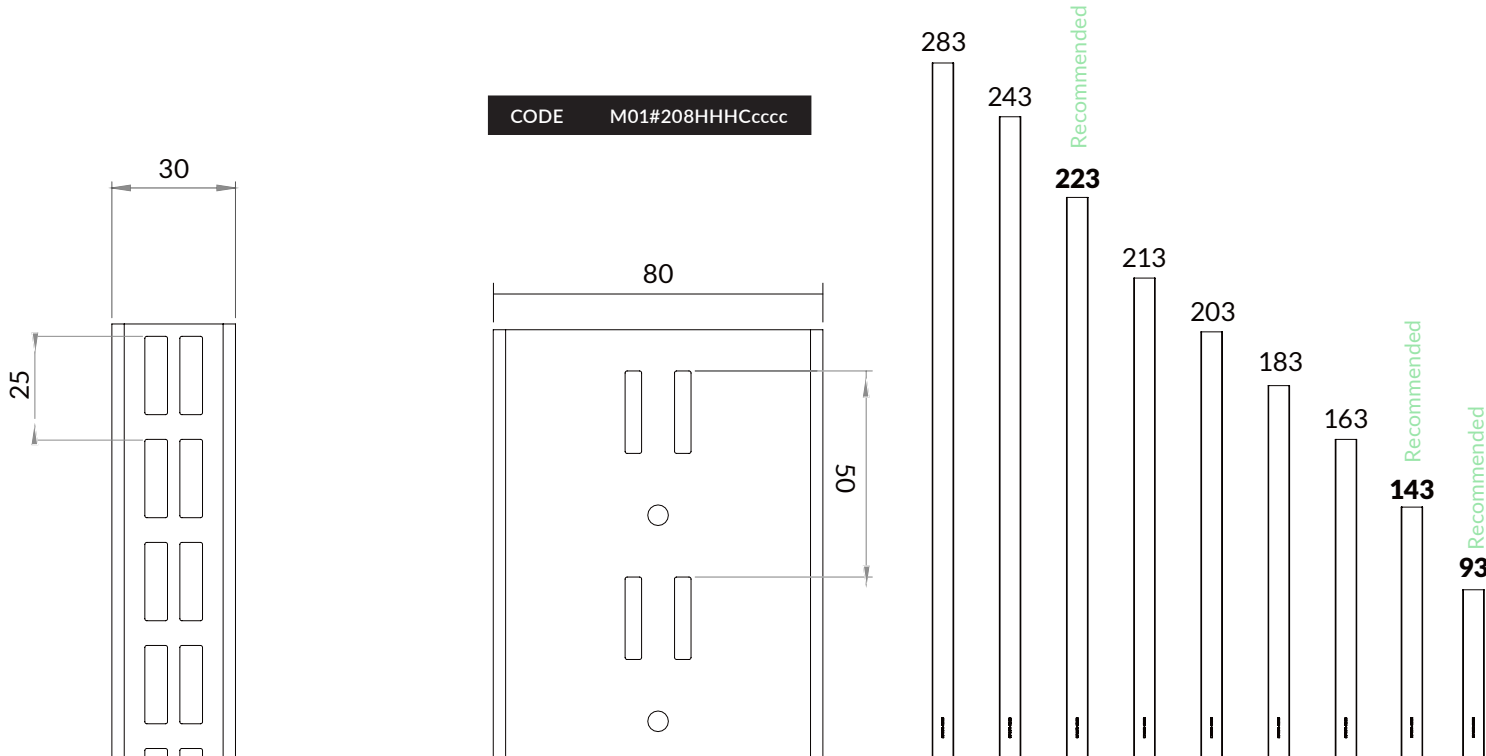

BASES

Base is available in H=10cm and unique connection with the upright.

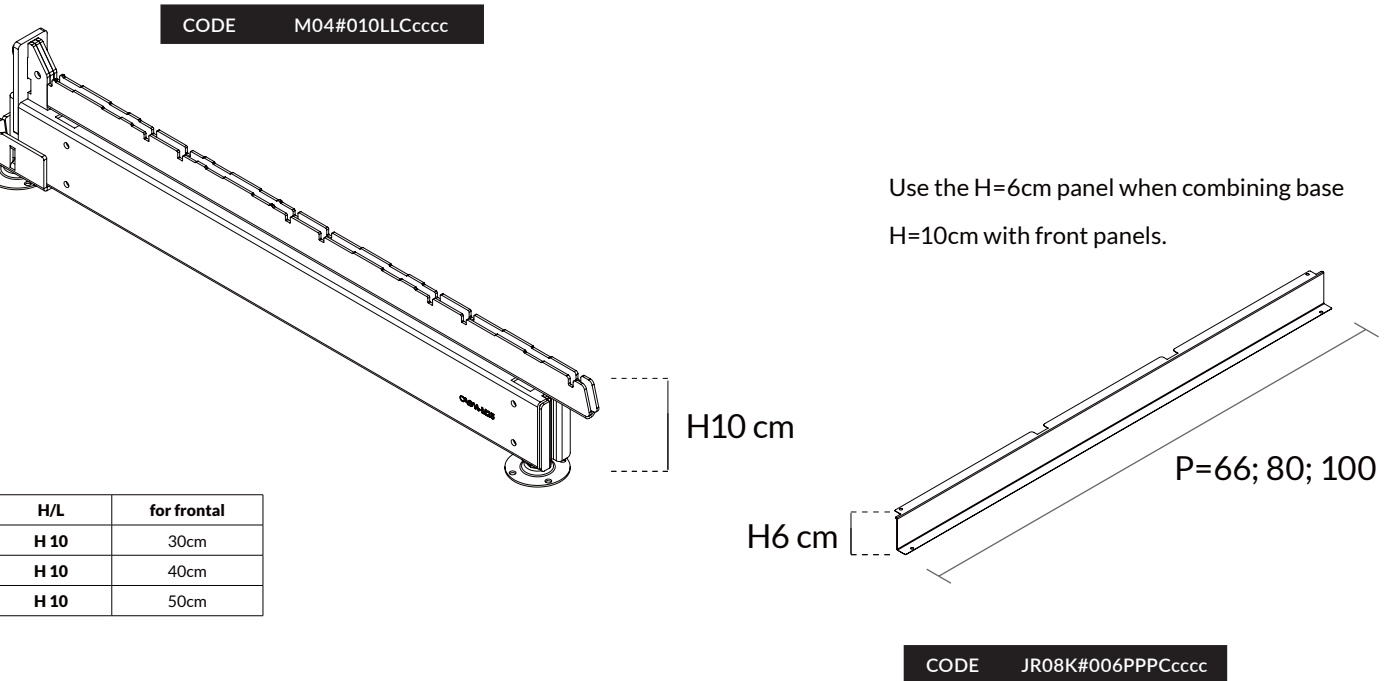

BACK PANELS

PLAIN FRONTAL BACK PANEL
USE BACK PANELS P=66 FOR CORNERS

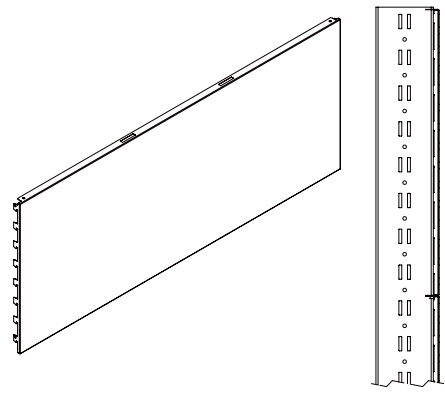

L/P	66	80	100
30	✓	✓	✓
40	✓	✓	✓

CONNECTION BETWEEN BACK PANEL

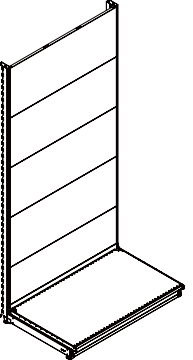
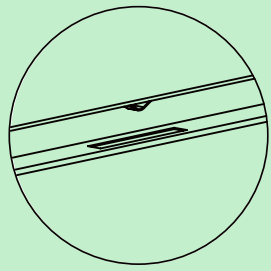

FRONTAL PLAIN BACK PANEL								
H B10	143	163	183	203	213	223	243	283
H 40CM	1	3	2	4	5	3	5	6
H 30CM	3	1	3	1	0	3	1	1
H 6CM	1	1	1	1	1	1	1	1

CORNER AAP

AAP SHELF

CODE 9PUK66109A#

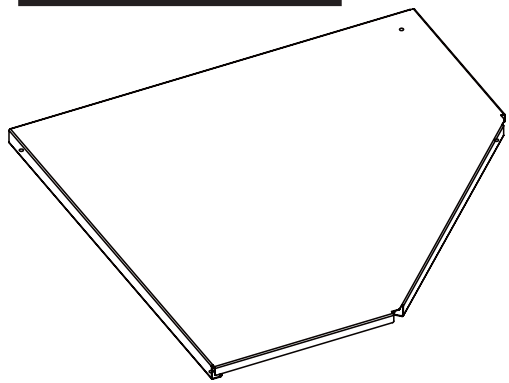

REAR SUPPORT BRACKET

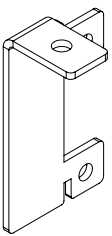

Metal corner shelf

CODE 9PUK66111A#

Timber corner shelf

CORNER UPRIGHT SUPPORT

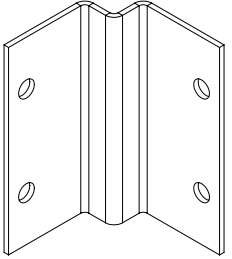

CODE 101D#30

FOOT SUPPORT FOR UPRIGHT

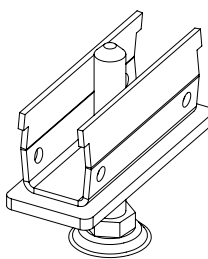

CODE M01L#08

SELF TAPPER

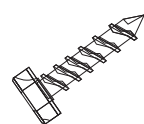

CODE 991#03A06316

WALL FIX BAR

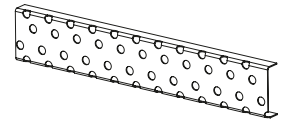

CODE 101D#41Z9997

SHELF

CODE S25C#XLLPPPCcccc

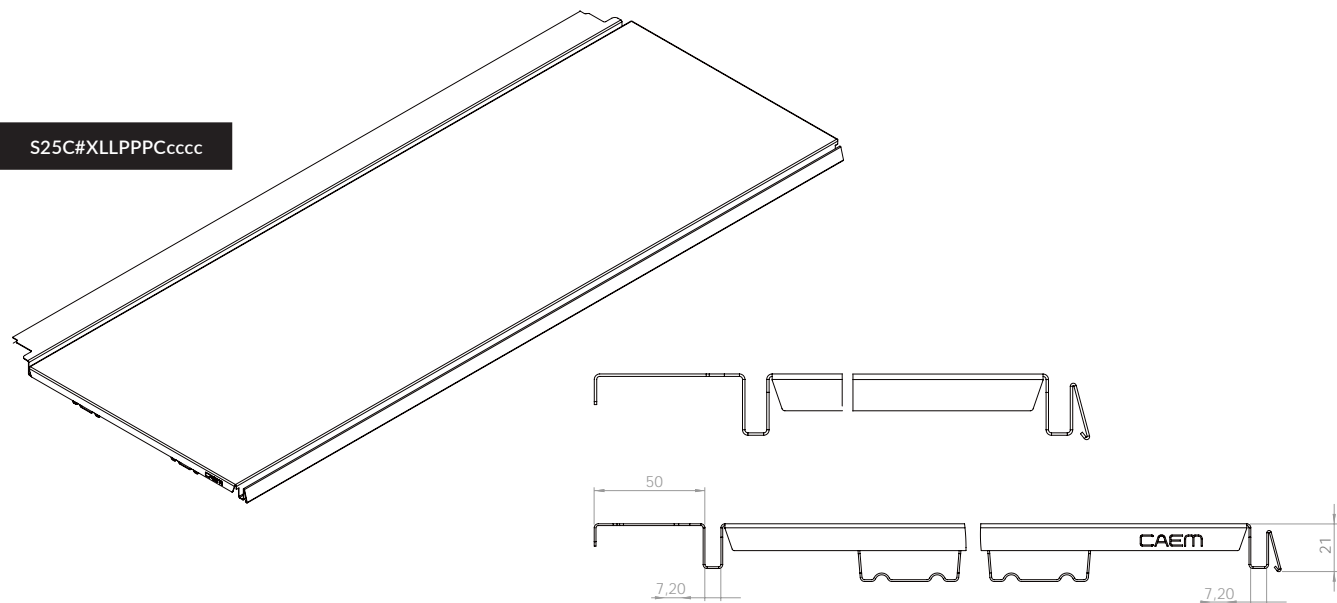

L/P	66	80	100
30	✓	✓	✓
40	✓	✓	✓
50	✓	✓	✓
60	✓	✓	✓



BRACKETS

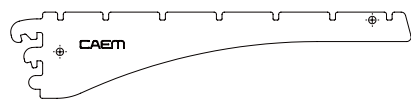

M25 Bracket 3 Holes 2 Positions L=30cm
CODE M10#330Ccccc

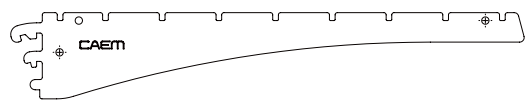

M25 Bracket 3 Holes 2 Positions L=40cm
CODE M10#340Ccccc

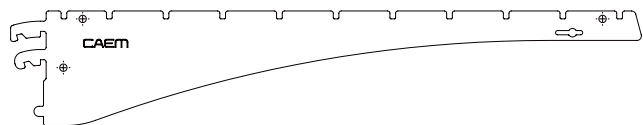

M25 Bracket 4 Holes 2 Positions L=50cm
CODE M10#450Ccccc

High Sided Bracket

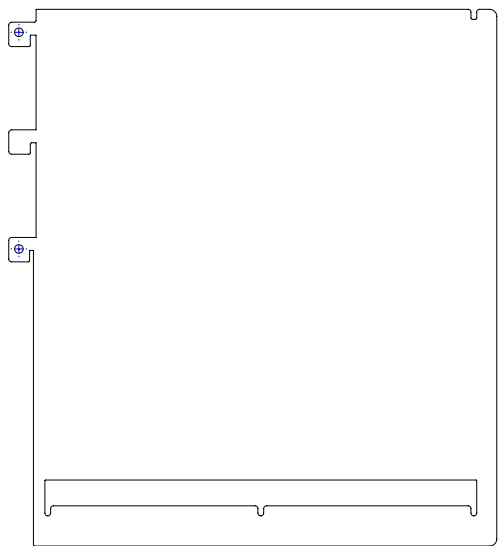

CODE 9PUK66102A#03830C

ACCESSORIES

TOP CAP

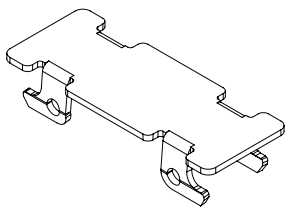

CODE M01C#08Ccccc

TOP COVER

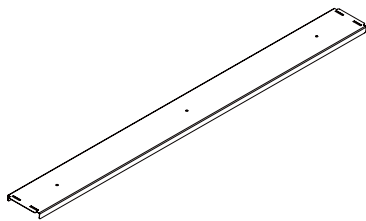

CODE M18P#08PPPCcccc

CONNECTION BAR

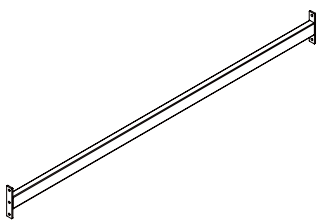

CODE 9PUK66102A#03830C

KICKER PANEL BASE SHELF

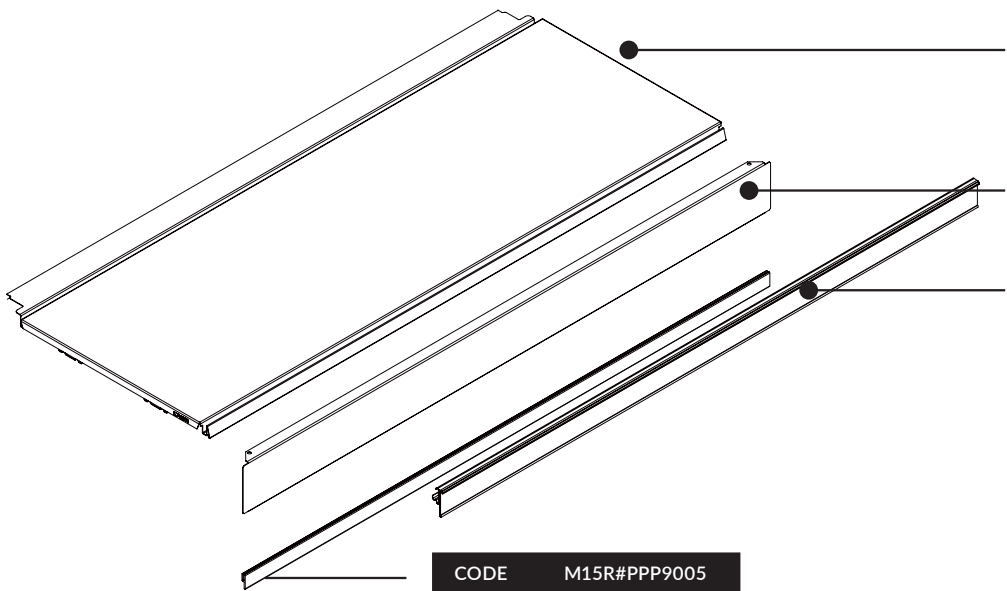

CODE S25C#XLLPPPCcccc

KICKER
CODE M15#010ppp

CODE M46#APPPSELF

CODE M15R#PPP9005

WALL FIX KIT

WALL FIX BRACKET

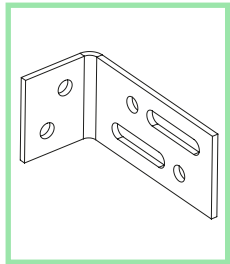

CODE 101D#11Z9997

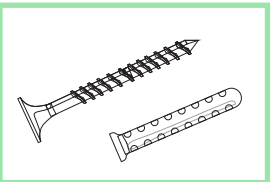

RAW PLUG
CODE 991#09000001
SCREW
CODE 991#01D06050

SELF TAPPER

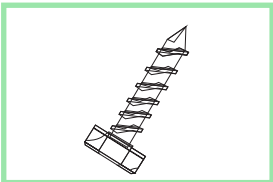

CODE 991#03A06316

WALL FIX BAR

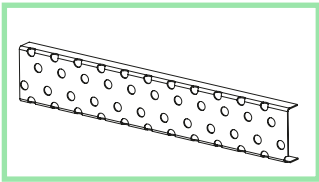

CODE 101D#41Z9997

TIMBER TOP

TIMBER TOP BRACKET

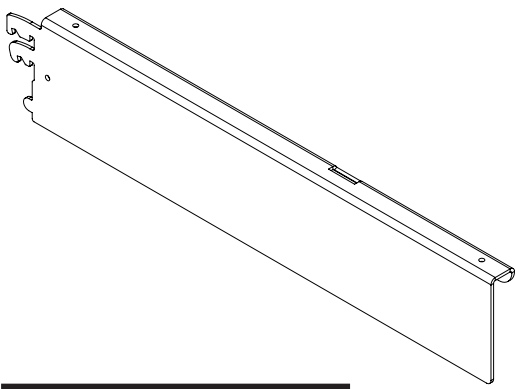

CODE 9PUK66104A#50LC (Left)
9PUK66104A#50RC (Right)

TIMBER TOP CROSS SUPPORT

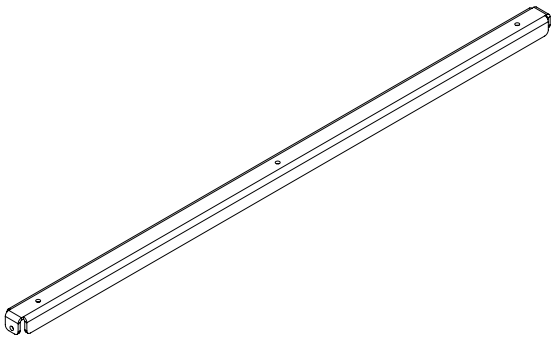

CODE 9PUK66105A#

WALL TIMBER TOP

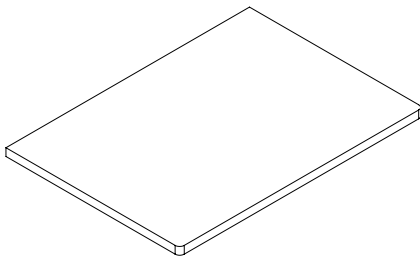

CODE 9PUK66107A#57xxx

GONDOLA TIMBER TOP

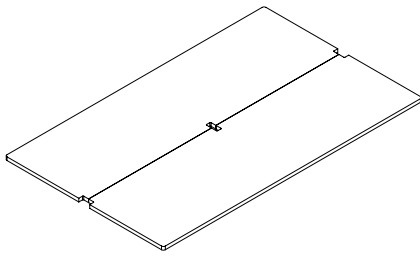

CODE 9PUK66112A#57

OVER THE TOP
GONDOLA TIMBER TOP

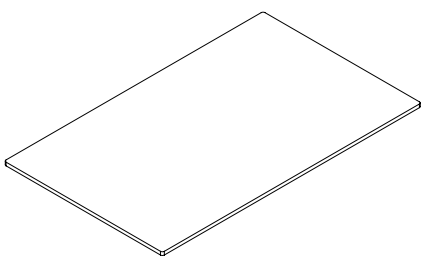

CODE 9PUK66118A#57xxx

AAP TIMBER TOP

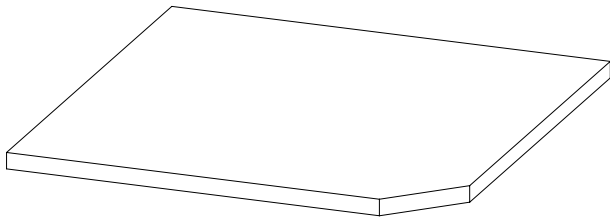

CODE 9PUK66118A#57xxx

TIMBER SIDES

TIMBER SIDE
GONDOLA HIGH

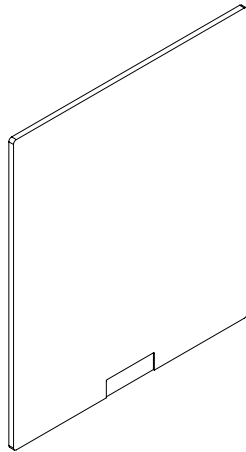

CODE 9PUK66116A#

TIMBER SIDE
GONDOLA LOW

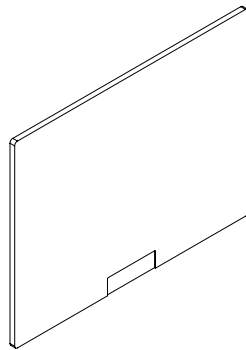

CODE 9PUK66116A#

TIMBER SIDE
WALL LOW

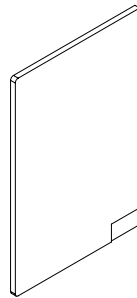

CODE 9PUK66115A#

TIMBER SIDE
WALL HIGH

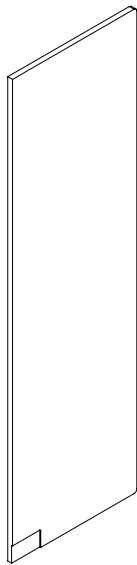

CODE 9PUK66115A#

TIMBER FINISHES

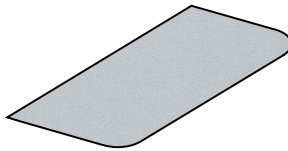

Silver Metallic T817



Black

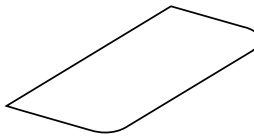

White



White Narcissus E106



Wenge Africa T552



Flax Penelope E203



Rock Penelope E202



Moka Penelope E201

Beton CEMENT

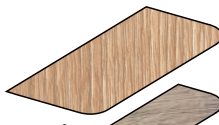

Durmast Pembroke S128



Durmast Tudor LDB6



Truffle D017



White Larch 0074



Ivory T810

Grey 1831



Vintage E063



Elm T762



Acacia Peach T041



Cherry Antique T088



Grey R879

Green R441

MEDIDRAWER

MEDIDRAWER H8CM

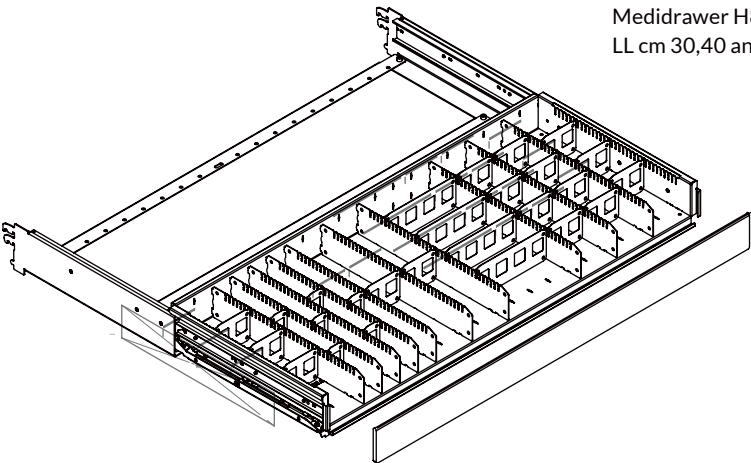

Medidrawer H8cm with acrylic front riser
LL cm 30,40 and 50 PPP cm 066, 080,100

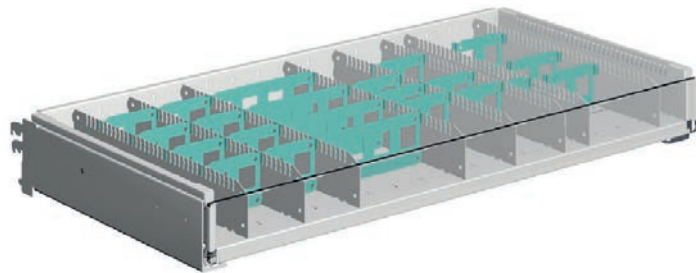

CODE 460#M008BBAAAC

PLAY OF LETTERS



D25 Play of Letters A to Z for Medidrawer and Readydrawer

CODE 9NUK90804A#

DIVIDERS - SIDE TO SIDE



8cm

9cm

SIDE TO SIDE DIVIDER
PERFORATED

CODE 461B#A00809C

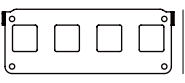

19cm

SIDE TO SIDE DIVIDER
PERFORATED

CODE 461B#A00819C

DIVIDERS - BACK TO FRONT

8cm

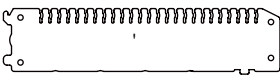

30cm

8cm

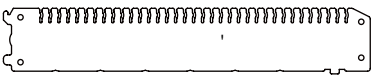

40cm

8cm



50cm

CODE 461A#A008xxCcccc

A very flexible divider system is available for Medidrawer: the pharmacist can create compartments in many sizes and they can be adjusted at any time in future. Vertical dividers can be placed very easily and placed at 48mm intervals. Horizontal dividers have windows to ease the pharmacist looking at drugs and can be placed between vertical dividers at intervals of 10mm.

MEDIDRAWER

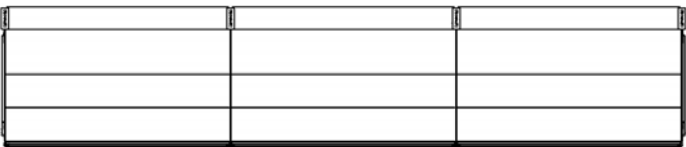
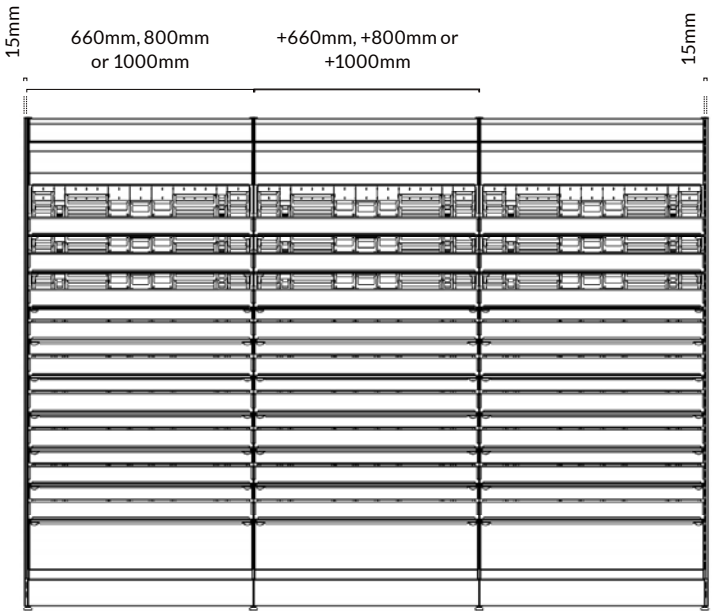

NET

NET

627mm, 762mm or 962mm

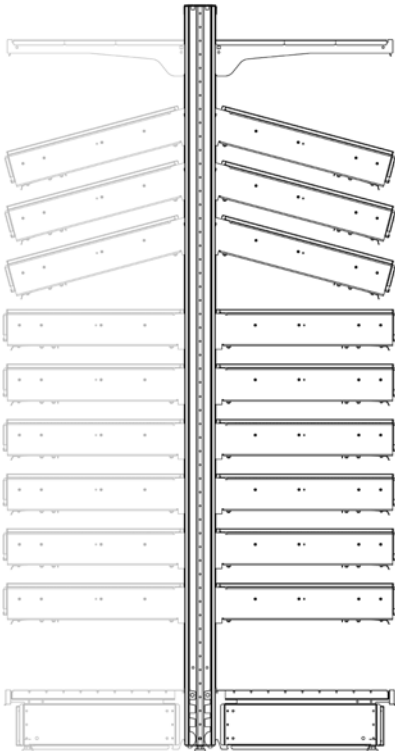
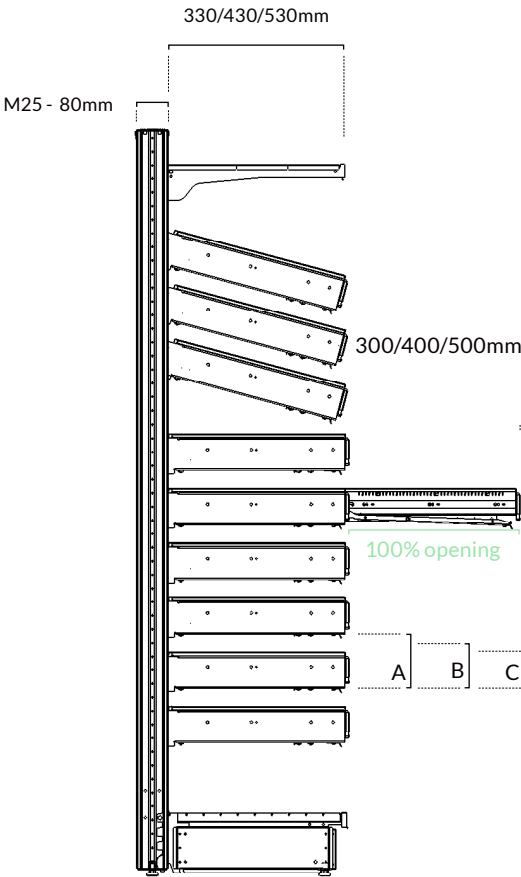

Sizes	M25
A	150mm + 25mm + 25mm...+40mm
B	100mm + 25mm + 25mm...+40mm
C	80mm

Performance	Weight Capacity	Reliability
30/40/50cm	27 kg	50.000 openings at 11 kg *
	60 lbs	50.000 openings at 24 lbs *
* Norm UNI 8581/84 - Norm FA 2/95		

READYDRAWER

READYDRAWER H17-H27 CM

Readydrawer L=40, 50 and P=66, 80, 100

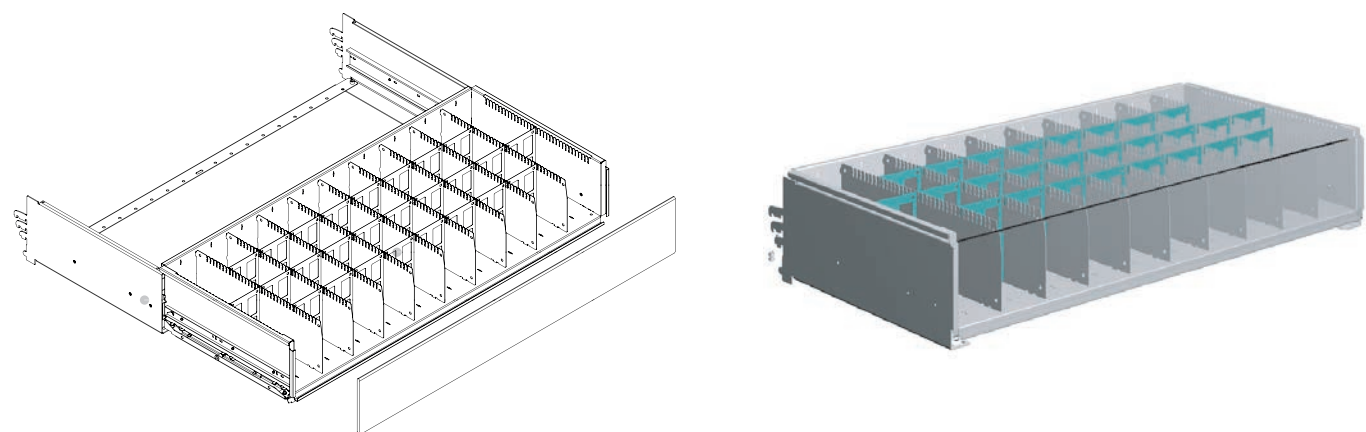

CODE 460SF#M015LLPPPCccc Order the fronts separately (see below)

FRONTAL
READYDRAWER 15 CLEAR

Plexi Clear front for Readydrawer
H=15cm (No Hole)

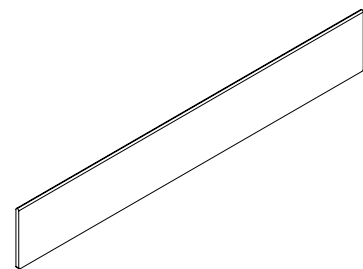

CODE 462#A08015PPPELF

FRONTAL
READYDRAWER 17

Plexi Opaque front for Readydrawer
H=17cm Frosted White

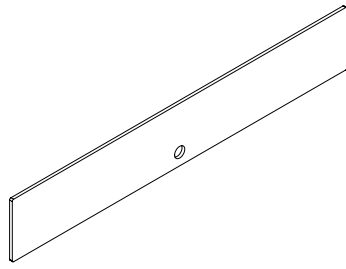

CODE 9PUK66106A#017PPPE25

FRONTAL
READYDRAWER 27

Plexi Opaque front for Readydrawer
H=27cm Frosted White

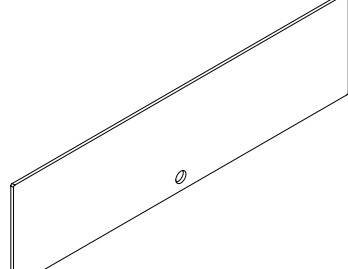

CODE 9PUK66106A#027PPPE25

DIVIDERS

BACK TO FRONT
DIVIDERS
READYDRAWER 40

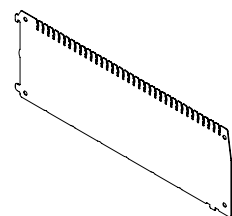

CODE 461A#AHHHLLc

BACK TO FRONT
DIVIDERS
READYDRAWER 50

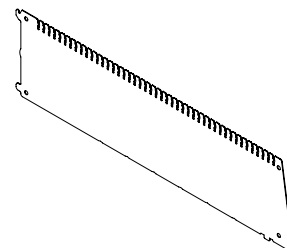

SIDE TO SIDE DIVIDERS
READYDRAWER 9

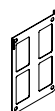

CODE 461B#AHHHLLc

SIDE TO SIDE DIVIDERS
READYDRAWER 19

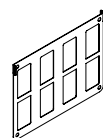

READYDRAWER

READYDRAWER H17-H27 CM

MEDIDRAWER H8 CM

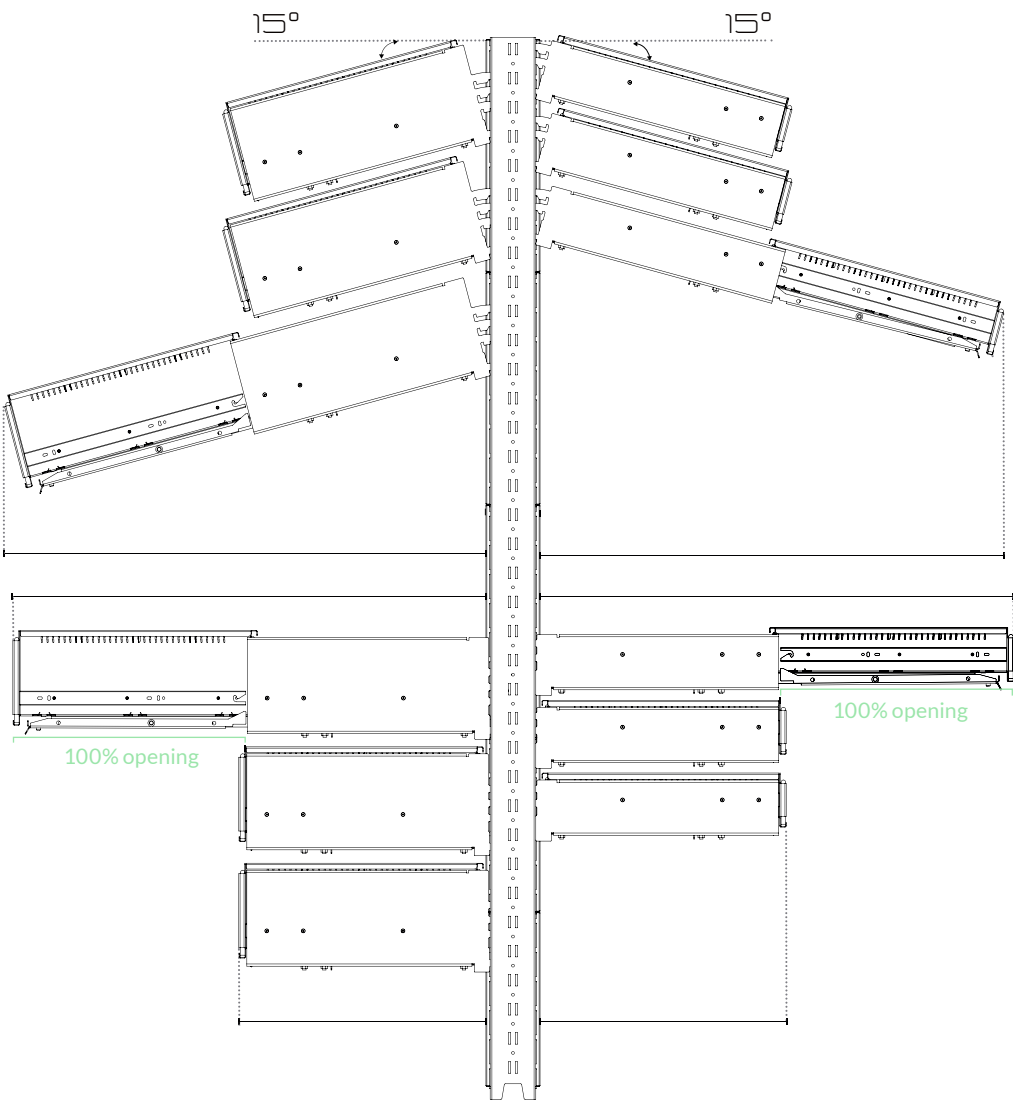

- READYDRAWER IN **LOCK IN** POSITION to secure a perfect closing of the device both when horizontal or inclined mounted.
- READYDRAWER IN **LOCK OUT** POSITION to allow the pharmacist to refill or pick up or browse through drugs.

D25 Play of Letters A to Z for Medidrawer and Readydrawer

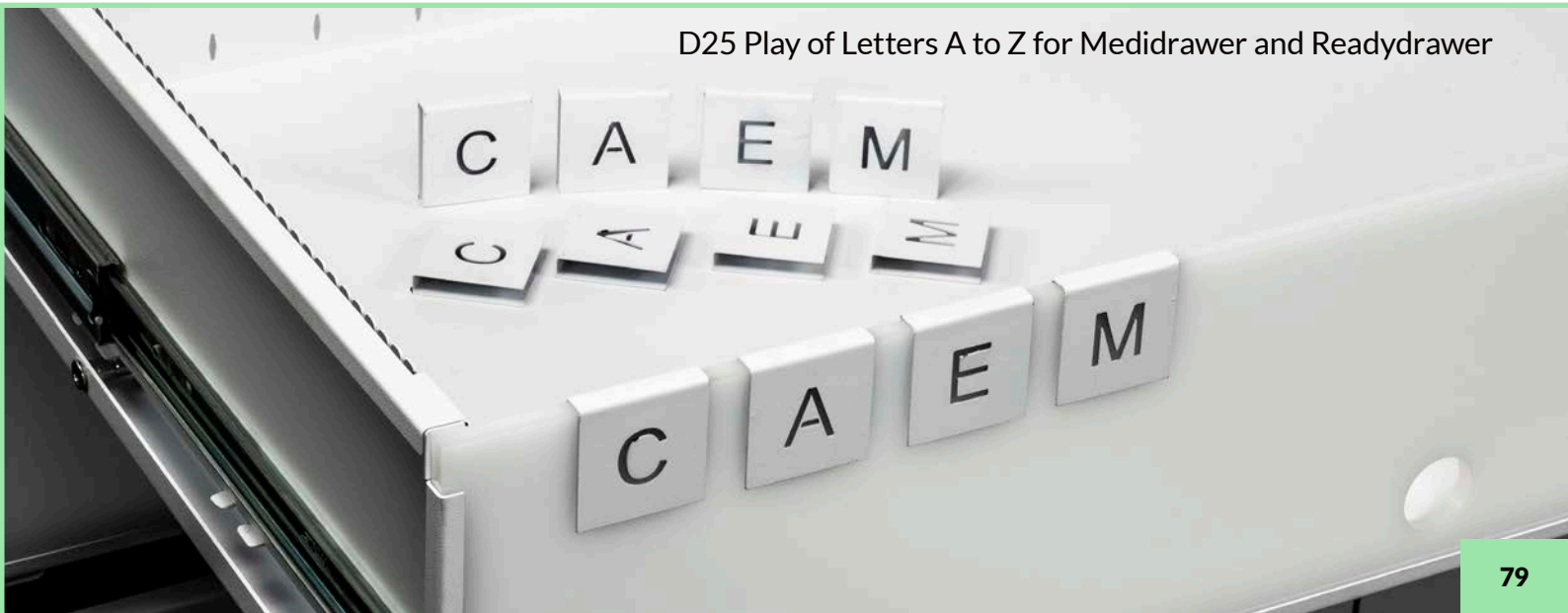

REVERSA SHELF

Shelves fit either way up, forming a shelf or a tray.

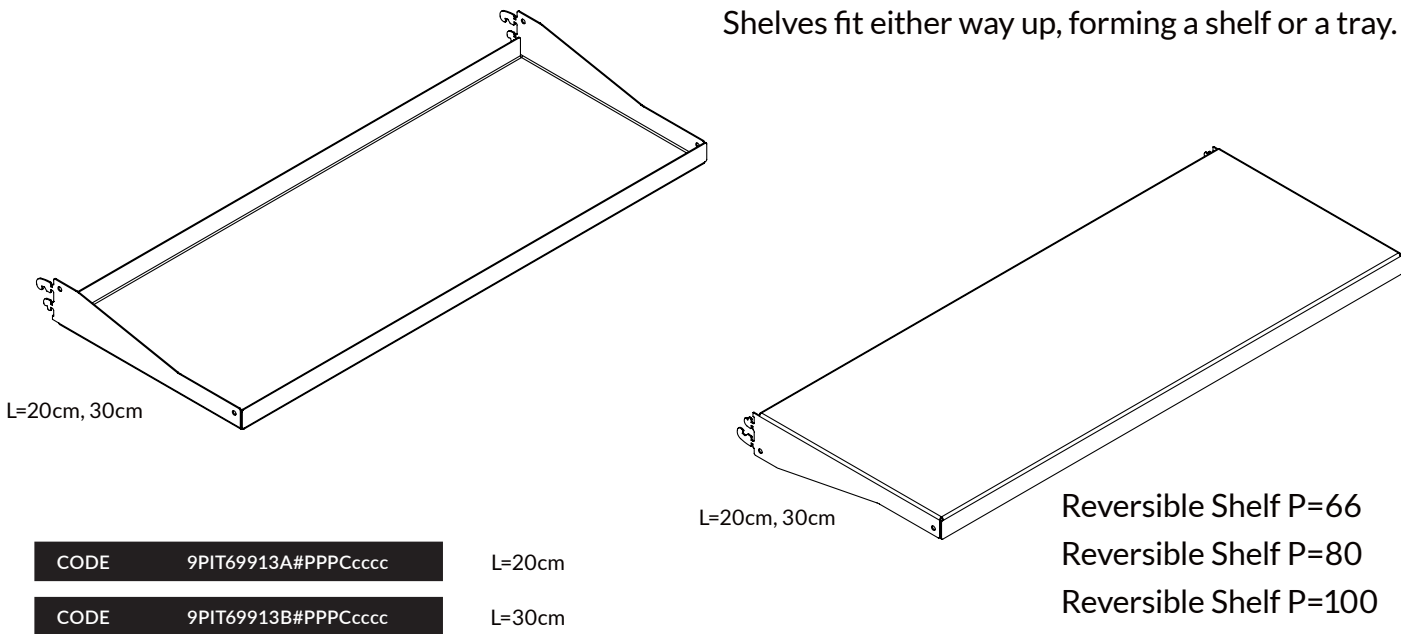

CODE	9PIT69913A#PPPCcccc	L=20cm
CODE	9PIT69913B#PPPCcccc	L=30cm

Reversible Shelf P=66
Reversible Shelf P=80
Reversible Shelf P=100

PULL OUT SHELVES

Pull Out Shelf P=66
Pull Out Shelf P=80

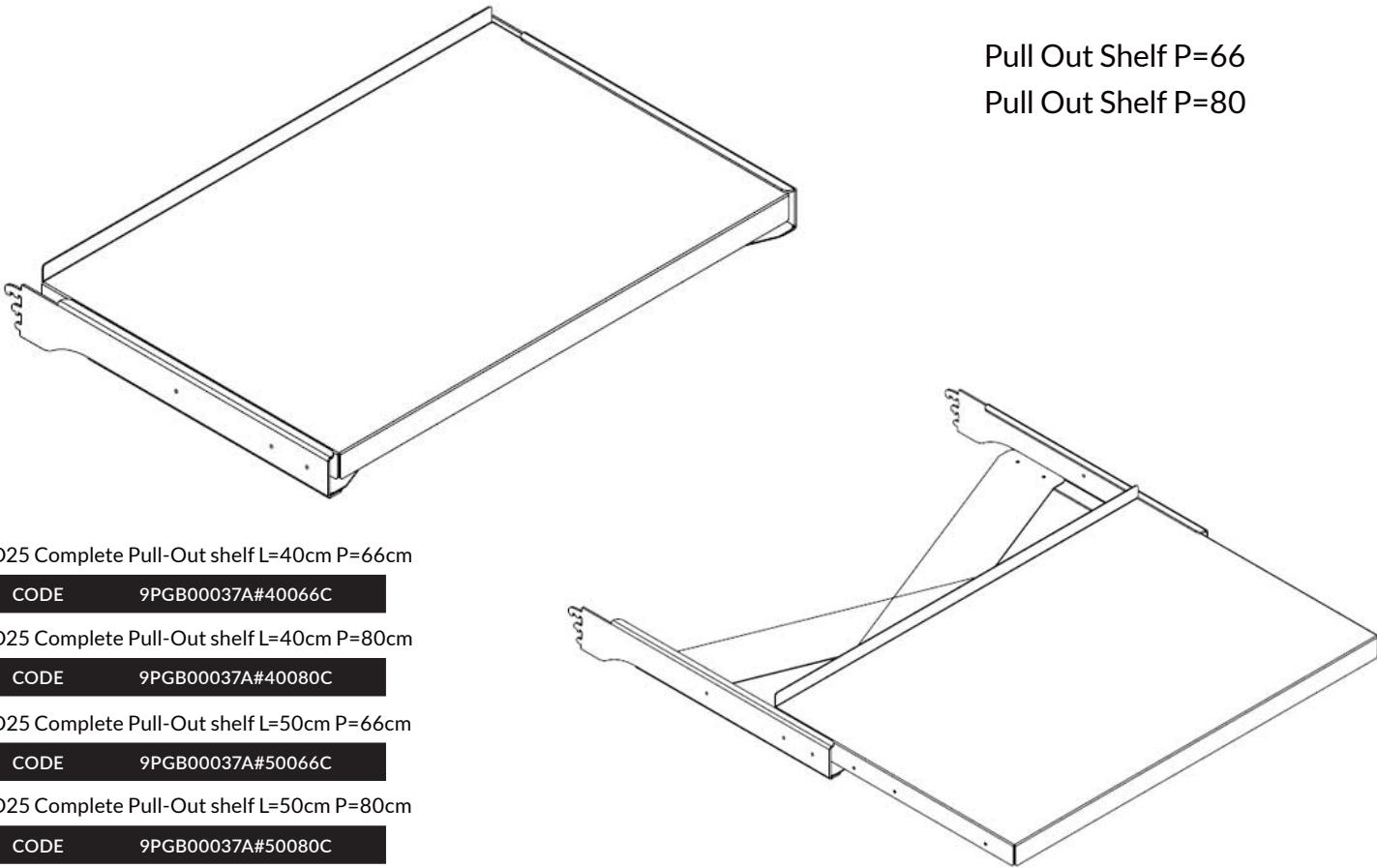

D25 Complete Pull-Out shelf L=40cm P=66cm	
CODE	9PGB00037A#40066C
D25 Complete Pull-Out shelf L=40cm P=80cm	
CODE	9PGB00037A#40080C
D25 Complete Pull-Out shelf L=50cm P=66cm	
CODE	9PGB00037A#50066C
D25 Complete Pull-Out shelf L=50cm P=80cm	
CODE	9PGB00037A#50080C

TRAYS AND BAR

STACK & NEST BIN BAR
M25 -Bar for trays D25

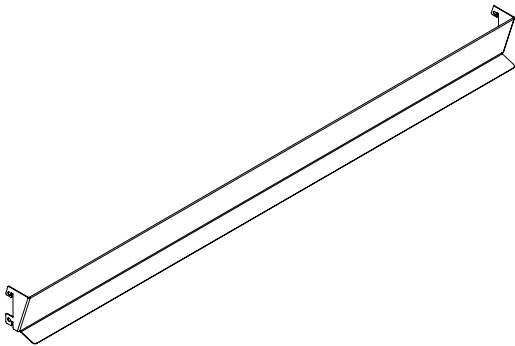

CODE	9PUK66114A#PPPCcccc
------	---------------------

D25 Stack&Nest Bins Bar P=66
D25 Stack&Nest Bins Bar P=80
D25 Stack&Nest Bins Bar P=100

STACK & NEST BIN

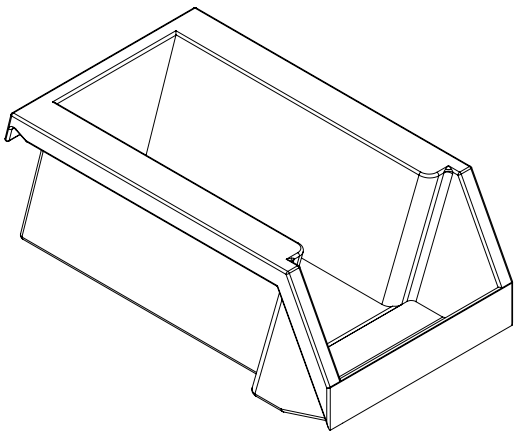

CODE	9PUK66150A#00814010
------	---------------------

D25 Stack&Nest Bin H=7.6 W=10.4 L=13.6 Opaque

CODE	9PUK66150A#00819010
------	---------------------

D25 Stack&Nest Bin H=7.6 W=10.4 L=18.7 Opaque

FLOORDRAWER

FLOOR DRAWER 23
M25 - Drawer under base shelf H=23cm

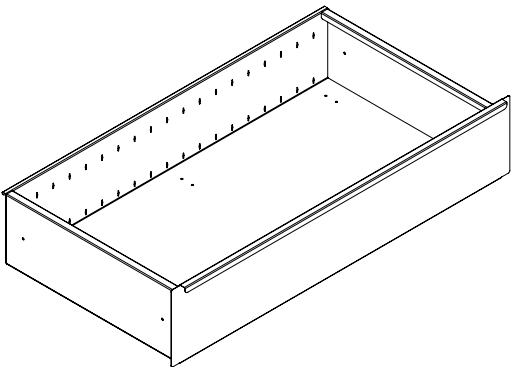

CODE	9PUK66101A#02340PPPCcccc	L=40cm
CODE	9PUK66101A#02350PPPCcccc	L=50cm

FLOOR DRAWER 43
M25 - Drawer under base shelf H=43cm

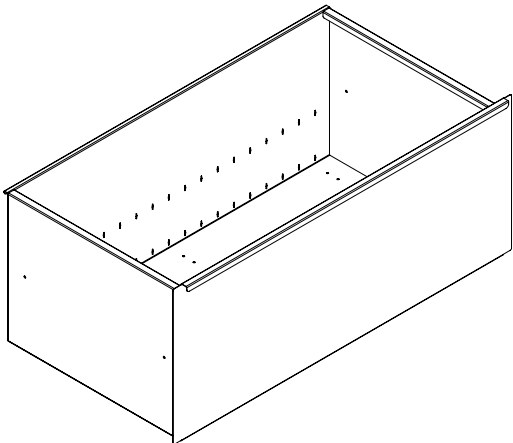

CODE	9PUK66101A#04340PPPCcccc	L=40cm
CODE	9PUK66101A#04350PPPCcccc	L=50cm

To organise FLOORDRAWER, use the same back-to-front and side-to-side dividers as READYDRAWER

WEIGHT LOADING

UPRIGHT 8 + BASE 10

CODES LIST

		66,5cm	80cm	100cm
SUSPENDED SHELVES	A = KG MAX ON ALL SUSPENDED SHELVES AA = KG MAX ON EACH SHELF	605		
		100	100	100
	A = KG MAX ON ALL SUSPENDED SHELVES AA = KG MAX ON EACH SHELF	479		
		100	100	100
	A = KG MAX ON ALL SUSPENDED SHELVES AA = KG MAX ON EACH SHELF	396		
		150	150	150
	A = KG MAX ON ALL SUSPENDED SHELVES AA = KG MAX ON EACH SHELF	338		
		125	125	125
	A = KG MAX ON ALL SUSPENDED SHELVES AA = KG MAX ON EACH SHELF	295		
		160	160	160
OTHERS	A = KG MAX ON ALL SUSPENDED SHELVES AA = KG MAX ON EACH SHELF	261		
		150	150	150
	MEDIDRAWER H=8CM	L = 30cm, 40cm, 50cm	X	27
	READYDRAWER H=17CM, H=27CM	L = 40cm, 50cm	X	27
	FLOORDRAWER H=23CM, 43CM	L = 40cm, 50cm	X	50
	BIN BSN	L = 14cm, 19cm		0.1

			66,5cm	80cm	100cm
BASE SHELF	B = KG MAX ON BASE SHELF	L=30cm	147	147	147
		L=40cm	151	151	151
		L=50cm	219	219	219
		L=60cm	222	222	222
		L=70cm	290	290	290
		L=80cm	292	292	292

			66,5cm	80cm	100cm
TOTAL	A + B = TOTAL KG MAX	L=30cm	752	752	752
		L=40cm	630	630	630
		L=50cm	615	615	615
		L=60cm	560	560	560
		L=70cm	585	585	585
		L=80cm	553	553	553

- WEIGHT LOADINGS ARE IN KG
- WEIGHT EVENLY DISTRIBUTED.
- SHELF MUST BE SAME OR SMALLER SIZE THAN BASE.
- SHELF L=30CM / 12" HAS 1 REINFORCEMENT
- SHELF L=40CM / 16" HAS 1 REINFORCEMENT
- SHELF L=50CM / 20" HAS 2 REINFORCEMENTS
- SHELF L=60CM / 24" HAS 2 REINFORCEMENTS

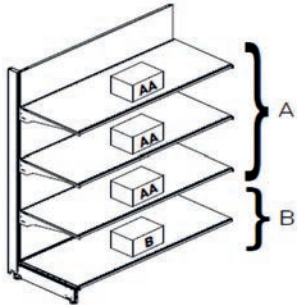

CODE	ITEM DESCRIPTION	SIZE	SIZE
M01#208143C	M25 - Upright 2 Side L=8cm H=143cm	8	143
M01#208163C	M25 - Upright 2 Side L=8cm H=163cm	8	163
M01#208183C	M25 - Upright 2 Side L=8cm H=183cm	8	183
M01#208203C	M25 - Upright 2 Side L=8cm H=203cm	8	203
M01#208213C	M25 - Upright 2 Side L=8cm H=213cm	8	213
M01#208223C	M25 - Upright 2 Side L=8cm H=223cm	8	223
M01#208243C	M25 - Upright 2 Side L=8cm H=243cm	8	243
M01#208283C	M25 - Upright 2 Side L=8cm H=283cm	8	283
M04#01027C	M25 - Base H=10cm L=27cm	10	27
M04#01030C	M25 - Base H=10cm L=30cm	10	30
M04#01037C	M25 - Base H=10cm L=37cm	10	37
M04#01040C	M25 - Base H=10cm L=40cm	10	40
M04#01047C	M25 - Base H=10cm L=47cm	10	47
M04#01050C	M25 - Base H=10cm L=50cm	10	50
M04#01057C	M25 - Base H=10cm L=57cm	10	57
M04#01060C	M25 - Base H=10cm L=60cm	10	60
9PIT61120A#143066C	M25 - Rear complete panel with slots TG SLIM H=143cm P=66cm	143	66
9PIT61120A#143080C	M25 - Rear complete panel with slots TG SLIM H=143cm P=80cm	143	80
9PIT61120A#143100C	M25 - Rear complete panel with slots TG SLIM H=143cm P=100cm	143	100
9PIT61120A#163066C	M25 - Rear complete panel with slots TG SLIM H=163cm P=66cm	163	66
9PIT61120A#163080C	M25 - Rear complete panel with slots TG SLIM H=163cm P=80cm	163	80
9PIT61120A#163100C	M25 - Rear complete panel with slots TG SLIM H=163cm P=100cm	163	100
M06#030066C	M25 - Central BackPanel H=30cm P=66cm	30	66
M06#030080C	M25 - Central BackPanel H=30cm P=80cm	30	80
M06#030100C	M25 - Central BackPanel H=30cm P=100cm	30	100
M06#040066C	M25 - Central BackPanel H=40cm P=66cm	40	66
M06#040080C	M25 - Central BackPanel H=40cm P=80cm	40	80
M06#040100C	M25 - Central BackPanel H=40cm P=100cm	40	100
JR08K#006066C	M25 - Front backpanel for baseH10 H=6cm P=66cm	6	66
JR08K#006080C	M25 - Front backpanel for baseH10 H=6cm P=80cm	6	80
JR08K#006100C	M25 - Front backpanel for baseH10 H=6cm P=100cm	6	100
JR08M#013066C	M25 - BackPanel Front Plain H=13cm P=66cm	13	66
JR08M#013080C	M25 - BackPanel Front Plain H=13cm P=80cm	13	80
JR08M#013100C	M25 - BackPanel Front Plain H=13cm P=100cm	13	100
JR08M#030066C	M25 - Front BackPanel Plain H=30cm P=66cm	30	66
JR08M#030080C	M25 - Front BackPanel Plain H=30cm P=80cm	30	80
JR08M#030100C	M25 - Front BackPanel Plain H=30cm P=100cm	30	100
JR08M#040066C	M25 - Front BackPanel Plain H=40cm P=66cm	40	66
JR08M#040080C	M25 - Front BackPanel Plain H=40cm P=80cm	40	80
JR08M#040100C	M25 - Front BackPanel Plain H=40cm P=100cm	40	100
JR07M#A040066C	M25 - Front BackPanel Perforated H=40cm P=66cm	40	66
JR07M#A040080C	M25 - Front BackPanel Perforated H=40cm P=80cm	40	80
JR07M#A040100C	M25 - Front BackPanel Perforated H=40cm P=100cm	40	100
JR08R#010066C	M25 - Strong Backpanel H=10cm P=66cm	10	66
JR08R#010080C	M25 - Strong Backpanel H=10cm P=80cm	10	80
JR08R#010100C	M25 - Strong Backpanel H=10cm P=100cm	10	100
M10#327C	M25 - Bracket 3 Holes L=27cm	27	0

CODES LIST

CODE	ITEM DESCRIPTION	SIZE	SIZE
M10#330C	M25 - Bracket 3 Holes L=30cm	30	0
M10#337C	M25 - Bracket 3 Holes L=37cm	37	0
M10#340C	M25 - Bracket 3 Holes L=40cm	40	0
M10#447C	M25 - Bracket 4 Holes L=47cm	47	0
M10#450C	M25 - Bracket 4 Holes L=50cm	50	0
M10#557C	M25 - Bracket 4 Holes L=57cm	57	0
M10#560C	M25 - Bracket 4 Holes L=60cm	60	0
S25C#130066C	M25 - Shelf 1 Reinf. L=30cm P=66cm	30	66
S25C#130080C	M25 - Shelf 1 Reinf. L=30cm P=80cm	30	80
S25C#130100C	M25 - Shelf 1 Reinf. L=30cm P=100cm	30	100
S25C#140066C	M25 - Shelf 1 Reinf. L=40cm P=66cm	40	66
S25C#140080C	M25 - Shelf 1 Reinf. L=40cm P=80cm	40	80
S25C#140100C	M25 - Shelf 1 Reinf. L=40cm P=100cm	40	100
S25C#250066C	M25 - Shelf 2 Reinf. L=50cm P=66cm	50	66
S25C#250080C	M25 - Shelf 2 Reinf. L=50cm P=80cm	50	80
S25C#250100C	M25 - Shelf 2 Reinf. L=50cm P=100cm	50	100
S25C#360066C	M25 - Shelf 3 Reinf. L=60cm P=66cm	60	66
S25C#360080C	M25 - Shelf 3 Reinf. L=60cm P=80cm	60	80
S25C#360100C	M25 - Shelf 3 Reinf. L=60cm P=100cm	60	100
M46#A066SELF	M25 - Epos for Shelf 'S25' Standard 'S25' P=66cm Clear PVC	0	66
M46#A080SELF	M25 - Epos for Shelf 'S25' Standard 'S25' P=80cm Clear PVC	0	80
M46#A100SELF	M25 - Epos for Shelf 'S25' Standard 'S25' P=100cm Clear PVC	0	100
M15#010066C	M25 - Kicker H=10cm P=66cm	10	66
M15#010080C	M25 - Kicker H=10cm P=80cm	10	80
M15#010100C	M25 - Kicker H=10cm P=100cm	10	100
M15R#0669005	M25 Rubber for Kicker P=66cm Black Pvc	0	66
M15R#0809005	M25 Rubber for Kicker P=80cm Black Pvc	0	80
M15R#1009005	M25 Rubber for Kicker P=100cm Black Pvc	0	100
9PIT61280P#08066C	M25 - Gondola Cover GE for Central Backpanel L=8cm P=66cm	8	66
9PIT61280P#08080C	M25 - Gondola Cover GE for Central Backpanel L=8cm P=80cm	8	80
9PIT61280P#08100C	M25 - Gondola Cover GE for Central Backpanel L=8cm P=100cm	8	100
M18P#08066C	M25 - Gondola Cover for Standard Backpanel L=8cm P=66cm	8	66
M18P#08080C	M25 - Gondola Cover for Standard Backpanel L=8cm P=80cm	8	80
M18P#08100C	M25 - Gondola Cover for Standard Backpanel L=8cm P=100cm	8	100
M01C#08C	M25 - Upright topcap 8x3	8	3
9PIT58301C#01027LC	M25 - Base Cover Std H=10 L=27cm Left	10	27
9PIT58301C#01027RC	M25 - Base Cover Std H=10 L=27cm Right	10	27
9PIT58301C#01030LC	M25 - Base Cover Std H=10 L=30cm Left	10	30
9PIT58301C#01030RC	M25 - Base Cover Std H=10 L=30cm Right	10	30
9PIT58301C#01037LC	M25 - Base Cover Std H=10 L=37cm Left	10	37
9PIT58301C#01037RC	M25 - Base Cover Std H=10 L=37cm Right	10	37
9PIT58301C#01040LC	M25 - Base Cover Std H=10 L=40cm Left	10	40
9PIT58301C#01040RC	M25 - Base Cover Std H=10 L=40cm Right	10	40
9PIT58301C#01047LC	M25 - Base Cover Std H=10 L=47cm Left	10	47
9PIT58301C#01047RC	M25 - Base Cover Std H=10 L=47cm Right	10	47
9PIT58301C#01050LC	M25 - Base Cover Std H=10 L=50cm Left	10	50
9PIT58301C#01050RC	M25 - Base Cover Std H=10 L=50cm Right	10	50
9PIT58301C#01057LC	M25 - Base Cover Std H=10 L=57cm Left	10	57
9PIT58301C#01057RC	M25 - Base Cover Std H=10 L=57cm Right	10	57
9PIT58301C#01060LC	M25 - Base Cover Std H=10 L=60cm Left	10	60
9PIT58301C#01060RC	M25 - Base Cover Std H=10 L=60cm Right	10	60
101D#11Z9997	Adjustable Wall Fix brackets Zinc	0	0
101D#41Z9997	Adjustable Wall Fix bar perf 100cm Zinc	0	0

CODES LIST

CODE	ITEM DESCRIPTION	SIZE	SIZE
9PIT58301A#08143C	M25 - Upright Side Cover L=8cm H=143cm	8	143
9PIT58301A#08163C	M25 - Upright Side Cover L=8cm H=163cm	8	163
9PIT58301A#08183C	M25 - Upright Side Cover L=8cm H=183cm	8	183
9PIT58301A#08203C	M25 - Upright Side Cover L=8cm H=203cm	8	203
9PIT58301A#08213C	M25 - Upright Side Cover L=8cm H=213cm	8	213
9PIT58301A#08223C	M25 - Upright Side Cover L=8cm H=223cm	8	223
9PIT58301A#08243C	M25 - Upright Side Cover L=8cm H=243cm	8	243
9PIT58301A#08283C	M25 - Upright Side Cover L=8cm H=283cm	8	283
9PIT58301N#08143C	M25 - Upright Side Cover For Baseless Unit L=8cm H=143cm	8	143
9PIT58301N#08163C	M25 - Upright Side Cover For Baseless Unit L=8cm H=163cm	8	163
9PIT58301N#08183C	M25 - Upright Side Cover For Baseless Unit L=8cm H=183cm	8	183
9PIT58301N#08203C	M25 - Upright Side Cover For Baseless Unit L=8cm H=203cm	8	203
9PIT58301N#08213C	M25 - Upright Side Cover For Baseless Unit L=8cm H=213cm	8	213
9PIT58301N#08223C	M25 - Upright Side Cover For Baseless Unit L=8cm H=223cm	8	223
9PIT58301N#08243C	M25 - Upright Side Cover For Baseless Unit L=8cm H=243cm	8	243
9PIT58301N#08283C	M25 - Upright Side Cover For Baseless Unit L=8cm H=283cm	8	283
451U#4020066C	M25 - Rear Support Bar 30cmx15cm P=66cm	30x15	66
451U#4020080C	M25 - Rear Support Bar 30cmx15cm P=80cm	30x15	80
451U#4020100C	M25 - Rear Support Bar 30cmx15cm P=100cm	30x15	100
M99#005C	M25 - Kit for Fixing Gondolaend	0	0
991#02A08000	M25 - Nut for Fixing Gondolaend	0	0
991#01A08020	M25 - Bolt for Fixing Gondolaend	0	0
991#06010000	M25 - Washer for Fixing Gondolaend	0	0
M99#002Z9997	M25 - Clip For Central Backpanel Zinc	0	0
M01L#08Z9997	M25 - Foot Support For Upright Zinc	0	0
101A#C	M25 - Adjustable Feet	0	0
991#03A06316	Acc's SELF TAPPERS 14x3/4 HEX HEAD (6.3mm Dia x 19mm Long Thread)	0	0
991#01D06050	Acc's Screw 10 / 5x2" Full Thread	0	0
991#09000001	Acc's PLUGS G.P. PLASTIC (GREY)	0	0
M22#P08066C	EPU Top Cover P=66cm	0	0
M22#P08080C	EPU Top Cover P=80cm	0	0
M22#P08100C	EPU Top Cover P=100cm	0	0
9PGB00036#340LC	D25 Bracket For Pull-Out Shelf 3 Notch L-40cm Left Hand	40	0
9PGB00036#340RC	D25 Bracket For Pull-Out Shelf 3 Notch L-40cm Right Hand	40	0
9PGB00036#350LC	D25 Bracket For Pull-Out Shelf 3 Notch L-50cm Left Hand	50	0
9PGB00036#350RC	D25 Bracket For Pull-Out Shelf 3 Notch L-50cm Right Hand	50	0
9PGB00036A#66C	D25 Strengthener For Pull-Out Shelf L=66cm	0	66
9PGB00036A#80C	D25 Strengthener For Pull-Out Shelf L=80cm	0	80
9PGB00036A#100C	D25 Strengthener For Pull-Out Shelf L=80cm	0	100
9PGB00037#40066C	D25 Tray for Pull-Out Shelf L=40cm P=66cm	40	66
9PGB00037#40080C	D25 Tray for Pull-Out Shelf L=40cm P=80cm	40	80
9PGB00037#400100C	D25 Tray for Pull-Out Shelf L=40cm P=100cm	40	100
9PGB00037#50066C	D25 Tray for Pull-Out Shelf L=50cm P=66cm	50	66
9PGB00037#50080C	D25 Tray for Pull-Out Shelf L=50cm P=80cm	50	80
9PGB00037#500100C	D25 Tray for Pull-Out Shelf L=50cm P=100cm	50	100
M99#002Z9997	M25 Clip No Pull-Out for Central Backpanels Zinc	0	0
460G#A40	Guide For MediDrawer No Self Closing (Mod. ET45) L=40cm	40	0
460G#A50	Guide For MediDrawer No Self Closing (Mod. ET45) L=50cm	50	0
9PGB00037A#50080C	D25 Complete Pull-Out shelf L=50cm P=80cm	50	0
9PGB00037A#50066C	D25 Complete Pull-Out shelf L=50cm P=66cm	50	0
9PGB00037A#40066C	D25 Complete Pull-Out shelf L=40cm P=66cm	50	0
9PGB00037A#40080C	D25 Complete Pull-Out shelf L=40cm P=80cm	50	0

CODE LIST OF D25 ITEMS

CODE	ITEM DESCRIPTION	SIZE	SIZE
9PIT69913A#066C	M25 - Reversible shelf L=20 P=66cm	20	66
9PIT69913A#080C	M25 - Reversible shelf L=20 P=80mm	20	80
9PIT69913A#0100C	M25 - Reversible shelf L=20 P=100cm	20	100
9PIT69913B#066C	M25 - Reversible shelf L=30 P=66cm	30	66
9PIT69913B#080C	M25 - Reversible shelf L=30 P=80mm	30	80
9PIT69913B#0100C	M25 - Reversible shelf L=30=100cm	30	100
460#M00830100C	D25 Medi_Drawer (incl. Riser) H=8 L=30 P=100	30	100
460#M00830080C	D25 Medi_Drawer (incl. Riser) H=8 L=30 P=80	30	80
460#M00830066C	D25 Medi_Drawer (incl. Riser) H=8 L=30 P=66	30	66
460#M00840100C	D25 Medi_Drawer (incl. Riser) H=8 L=40 P=100	40	100
460#M00840080C	D25 Medi_Drawer (incl. Riser) H=8 L=40 P=80	40	80
460#M00840066C	D25 Medi_Drawer (incl. Riser) H=8 L=40 P=66	40	66
460#M00850100C	D25 Medi_Drawer (incl. Riser) H=8 L=50 P=100	50	100
460#M00850080C	D25 Medi_Drawer (incl. Riser) H=8 L=50 P=80	50	80
460#M00850066C	D25 Medi_Drawer (incl. Riser) H=8 L=50 P=66	50	66
461A#A00830C	D25 Medi_Drawer Metal Back-to-Front Divider H=8 L=30	8	30
461A#A00840C	D25 Medi_Drawer Metal Back-to-Front Divider H=8 L=40	8	40
461A#A00850C	D25 Medi_Drawer Metal Back-to-Front Divider H=8 L=50	8	50
461B#A00809C	D25 Medi_Drawer Metal Side-to-Side Divider H=8 P=10	8	10
461B#A00819C	D25 Medi_Drawer Metal Side-to-Side Divider H=8 P=20	8	20
460SF#M01540100C	D25 Ready_Drawer (without Riser) L=40 P=100	40	100
460SF#M01540080C	D25 Ready_Drawer (without Riser) L=40 P=80	40	80
460SF#M01540066C	D25 Ready_Drawer (without Riser) L=40 P=66	40	66
460SF#M01550100C	D25 Ready_Drawer (without Riser) L=50 P=100	50	100
460SF#M01550080C	D25 Ready_Drawer (without Riser) L=50 P=80	50	80
460SF#M01550066C	D25 Ready_Drawer (without Riser) L=50 P=66	50	66
9PUK66106#A#017100XE25	D25 Ready_Drawer Acrylic Riser with Finger Hole H=17 P=100	17	100
9PUK66106#A#017080XE25	D25 Ready_Drawer Acrylic Riser with Finger Hole H=17 P=80	17	80
9PUK66106#A#017066XE25	D25 Ready_Drawer Acrylic Riser with Finger Hole H=17 P=66	17	66
9PUK66106#A#027100XE25	D25 Ready_Drawer Acrylic Riser with Finger Hole H=27 P=100	27	100
9PUK66106#A#027080XE25	D25 Ready_Drawer Acrylic Riser with Finger Hole H=27 P=80	27	80
9PUK66106#A#027066XE25	D25 Ready_Drawer Acrylic Riser with Finger Hole H=27 P=66	27	66
462#A08015100SELF	D25 Ready_Drawer Clear Acrylic Riser with No Finger Hole H=15 P=100	17	100
462#A08015066SELF	D25 Ready_Drawer Clear Acrylic Riser with No Finger Hole H=15 P=66	17	66
462#A08015080SELF	D25 Ready_Drawer Clear Acrylic Riser with No Finger Hole H=15 P=80	17	80
461A#A01540C	D25 Ready_Drawer Metal Back-to-Front Divider H=15 L=40	15	40
461A#A01550C	D25 Ready_Drawer / Floor_Drawer Metal Back-to-Front Divider H=15 L=50	15	50
461B#A01509C	D25 Ready_Drawer / Floor_Drawer Metal Side-to-Side Divider H=15 P=10	15	10
461B#A01519C	D25 Ready_Drawer / Floor_Drawer Metal Side-to-Side Divider H=15 P=20	15	20
9NUK90804A#	D25 Play of Letters A to Z for Medi_Drawer and Ready_Drawer Risers	3	3
9PUK66101A#04350100C	D25 Floor_Drawer H=43 L=50 P=100	50	100
9PUK66101A#04340100C	D25 Floor_Drawer H=43 L=40 P=100	40	100
9PUK66101A#04350080C	D25 Floor_Drawer H=43 L=50 P=80	50	80
9PUK66101A#04340080C	D25 Floor_Drawer H=43 L=40 P=80	40	80
9PUK66101A#04350066C	D25 Floor_Drawer H=43 L=50 P=66	50	66
9PUK66101A#04340066C	D25 Floor_Drawer H=43 L=40 P=66	40	66
9PUK66101A#02350100C	D25 Floor_Drawer H=23 L=50 P=100	50	100
9PUK66101A#02340100C	D25 Floor_Drawer H=23 L=40 P=100	40	100
9PUK66101A#02350080C	D25 Floor_Drawer H=23 L=50 P=80	50	80
9PUK66101A#02340066C	D25 Floor_Drawer H=23 L=40 P=80	40	80
9PUK66101A#02350066C	D25 Floor_Drawer H=23 L=50 P=66	50	66
9PUK66101A#02340066C	D25 Floor_Drawer H=23 L=40 P=66	40	66

CODE	ITEM DESCRIPTION	SIZE	SIZE
9PUK66150A#008140100020	D25 Stack&Nest Tray H=76 W=104 L=136 Opaque	7,6	13,6
9PUK66150A#008190100020	D25 Stack&Nest Tray H=76 W=104 L=187 Opaque	7,6	18,7
9PUK66114A#066C	D25 Stack&Nest Trays Bar P=66	5	66
9PUK66114A#080C	D25 Stack&Nest Trays Bar P=80	5	80
9PUK66114A#100C	D25 Stack&Nest Trays Bar P=100	5	100
9PUK66102A#03830C	M25 High Sided Bracket H=30 L=30	30	30
9PUK66104A#50LC/RC	D25 Timber Top Bracket L=520mm L/R	10	52
9PUK66105A#066C	D25 Timber Top Cross Support P=66	3	66
9PUK66105A#080C	D25 Timber Top Cross Support P=80	3	80
9PUK66105A#100 C	D25 Timber Top Cross Support P=100	3	100
9PUK66110A#	D25 Timber Top H=25mm None Cut out L=57 P=AAP *For Pricing Only - Send Worktop Layout.	57	66
9PUK66107A#	D25 Timber Top H=25mm None Cut out L=57 P=80 *For Pricing Only - Send Worktop Layout.	57	80
9PUK66107A#	D25 Timber Top H=25mm None Cut out L=57 P=100 *For Pricing Only - Send Worktop Layout.	57	100
9PUK66112A#	D25 Timber Top H=25mm With 5cm Extended Cut out L=57 P=66 *For Pricing Only - Send Worktop Layout.	62	66
9PUK66112A#	D25 Timber Top H=25mm With 5cm Extended Cut out L=57 P=80 *For Pricing Only - Send Worktop Layout.	62	80
9PUK66112A#	D25 Timber Top H=25mm With 5cm Extended Cut out L=57 P=100 *For Pricing Only - Send Worktop Layout.	62	100
9PUK66118A#	D25 Timber Top H=25mm With 10cm Extended Cut out L=57 P=66 *For Pricing Only - Send Worktop Layout.	66	66
9PUK66118A#	D25 Timber Top H=25mm With 10cm Extended Cut out L=57 P=80 *For Pricing Only - Send Worktop Layout.	66	80
9PUK66118A#	D25 Timber Top H=25mm With 10cm Extended Cut out L=57 P=100 *For Pricing Only - Send Worktop Layout.	66	100
9PUK66115A#	D25 Timber Side Wall 25mm H=95 L=57 *For Pricing Only - Send Worktop Layout.	66	95
9PUK66115A#	D25 Timber Side Wall 25mm H=223 L=57 *For Pricing Only - Send Worktop Layout.	66	223
9PUK66116A#	D25 Timber Side Gondola 25mm H=95 L=124 *For Pricing Only - Send Worktop Layout.	124	95
9PUK66116A#	D25 Timber Side Gondola 25mm H=143 L=124 *For Pricing Only - Send Worktop Layout.	124	143
9PUK66116A#	D25 Timber Side Gondola 25mm H=143 L=124 *For Pricing Only - Send Worktop Layout.	124	143
991#08010025	D25 Insert for Leveller for Timber Sides (use Two on each timber side)	1	1
991#04C03945	Acc's Self Tap Timber Screw TC D=3.9 L=45		4,5
9PUK66111A#C	M25 Corner AAP Shelf Bracket	5	5
9PUK66113A#C	M25 Corner AAP Timber Bracket	5	5
101D#30Z9997	M25 Corner AAP Uprights Locking Clamp	5	10
M01L#08C	M25 Uprights Insert When No Base	3	8
101A#C	Plastic Foot for Upright / Bases 10x40	3	8
9PIT60001A#066C	M25 - Single Connection Bar P=066cm	4*2	66
9PIT60001A#080C	M25 - Single Connection Bar P=080cm	4*2	80
9PIT60001A#100C	M25 - Single Connection Bar P=100cm	4*2	100
9PUK66109A#30C	M25 Shelf S25C Corner AAP L=30	66	30
9PUK66109A#40C	M25 Shelf S25C Corner AAP L=40	66	40
9PUK66109A#50C	M25 Shelf S25C Corner AAP L=50	66	50
M15A#01030ABPC	M25 Kicker H10 AAP L=30	10	40
M15A#01040ABPC	M25 Kicker H10 AAP L=40	10	30
M15A#01050ABPC	M25 Kicker H10 AAP L=50	10	20

Installation guides are available in video format.

Please visit:

www.caem.co.uk/downloads

TERMS AND CONDITIONS

1. Definitions	
In this document, the following words shall have the following meanings:	
"Agreement"	means these Terms and Conditions, together with the terms of any applicable Order Acknowledgement or Order Confirmation
"Customer" (or "The Buyer")	means the organisation or person who purchases goods and services from the Supplier
"Intellectual Property Rights"	means all patents, registered and unregistered designs, copyright, trademarks, know-how and all other forms of intellectual property wherever in the world enforceable
"Order Acknowledgement/ Confirmation"	means a statement of work, quotation or other similar document describing the goods and/or services to be provided by the Supplier
"Supplier" (or "THE SUPPLIER")	means Magrini (UK) Limited T/A CAEM, Unit 3 Jamage Industrial Estate, Talke, Stoke-on-Trent, Staffordshire, ST7 1XW - UK

- 2. General**
- 2.1. These Terms and Conditions shall apply to all contracts for the supply of goods and/or services by the Supplier to the Customer.
- 2.2. The customer should submit their order in writing. Before the commencement of the supply of goods, the Supplier shall submit to the Customer an order acknowledgement or order confirmation, which shall specify the goods and services to be supplied and the price payable. The Customer shall notify the Supplier immediately if the Customer does not agree with the contents of the order acknowledgement. All order acknowledgements shall be subject to these Terms and Conditions. The Customer shall be responsible for issuing a purchase order before any goods and services are supplied.
- 2.3. The Supplier shall use all reasonable endeavours to complete the services within estimated time frames, but time shall not be of the essence in the performance of any services.

- 3. Price and Payment**
- 3.1. The Supplier prices stated on price lists and quotations are based on EXW – ST7 1XW
- 3.2. Delivery services can be arranged and will be charged separately.
- 3.3. Quotations are valid for 30 days from the date of the quote.
- 3.4. Goods will be invoiced when delivery has been completed to the agreed delivery address, unless otherwise agreed in writing.
- 3.5. The price for the supply of goods and/or services are as set out in the quotation and or order acknowledgement. Payment terms and customer credit limits are as agreed and confirmed by the Supplier when the initial Customer account set up procedure takes place. These terms will also be displayed on all invoices.
- 3.6. In the case of customer rollouts, an additional handling charge may be added for additional administration, labour and packaging. This will be communicated by the Supplier when the quotation is sent.
- 3.7. The Supplier reserves the right to refuse to execute any order or contract if the arrangements for payment or the credit of the Buyer appear to be or have become unsatisfactory. Credit limits will be monitored regularly and amended where necessary using an external credit checking company.
- 3.8. The Supplier accepts payment by the following methods: cheque, BACS or by card via a payment link. The Supplier does not accept any form of cash payment.
- 3.9. Invoiced amounts shall be due and payable in compliance with terms detailed in the Order Acknowledgement. The Supplier shall be entitled to charge interest on overdue invoices from the date when payment becomes due, from day to day until the date of payment. This is at a rate of 8.00% per annum above the base rate of the Bank of England.
- 3.10. Should a debt collection services be necessary to retrieve monies outstanding, the Customer will be liable for all costs incurred.

- 4. Specification of the Goods**
- 4.1. All goods shall be required only to conform to the specification in the Order Acknowledgement. For the avoidance of doubt, no description, specification or illustration contained in any product brochure or other sales/marketing literature of the Supplier and no representation written or oral, correspondence or statement shall form part of the contract.
- 4.2. The shelving weight loading is specified in the technical catalogues.
- 4.3. The Supplier reserves the right to change any information in the technical catalogues, brochures etc (including models, sizes, lead time, etc) at any time and without notice.
- 4.4. The goods will be packaged in accordance to the courier specified by the Customer or organised by the Supplier for the Customer. The customer remains liable for appropriate disposal of all packaging materials and its recycling.
- 4.5. The Supplier is not liable for packaging being deemed inappropriate for the goods,
- 4.6. The Supplier is not liable for any cost or responsibility arising from the mix of packaging and pallets within a trailer. The Supplier endeavour to pack products safely and as efficiently as possible to minimise transport costs, but remains not liable for such costs and their optimisation.

- 5. Delivery / Collections**
- Delivery / Collections
- 5.1. Our terms of sales are FCA – ST7 1XW unless specified otherwise in writing under INCOTERMS 2020 conditions.
- 5.2. May a delivery be organised for the Customer by the Supplier terms of sale are DPU – (Address/Postcode of delivery) under INCOTERMS 2020.
- 5.3. The date of delivery specified by the Supplier is an estimate only. Time for delivery shall not be of the essence of the contract, and the Supplier shall not be liable for any loss, costs, damages, charges or expenses caused directly or indirectly by any delay in the delivery of the goods. This includes if deliveries are delayed that are out of the control of the Supplier such as weather or traffic.
- 5.4. The Customer shall pay for the delivery cost and the re-delivery cost where deliveries not able to be made where there are any restrictions in place, which the Supplier has not been made aware of.
- 5.5. Unless the contract provides to the contrary, the supplier may deliver by instalments. This will be communicated to the customer prior to delivery. Each instalment will be invoiced upon delivery and will be payable when each invoice falls due – regardless of whether the whole order has been delivered in full.
- 5.6. All risk in the goods shall pass to the Customer upon delivery.
- 5.7. Unless otherwise expressly agreed in writing, delivery shall be made by the Supplier's chosen delivery/ Courier Company. If the customer is to arrange to collect the goods, this will take place at the premises of the Supplier and the Supplier shall load the Goods on the vehicle provided by the Buyer.
- 5.8. If Goods are not collected within 5 working days of the agreed collection date, the goods will be delivered to the Customer's head office at the cost of the customer.
- 5.9. If agreed delivery charges are delayed and the customer requires the Supplier to hold the product, storage charges may be incurred by the Customer
- 5.10. For goods ultimately destined for delivery abroad, the Supplier will endeavour to submit the origin of each component under the 'origin of goods' international regulation. May the Supplier organise a delivery for the Customer abroad of the UK, the Supplier will prepare all documentation in good faith. The Customer remains responsible for the documentation and the duty process through the custom at the other side. The Supplier remains not liable for any costs incurred in the process for extra transport costs at customs due to delays with the paperwork, demurrages and any other possible claim.

- 6. Installation**
- 6.1. May the Customer require the installation of shelving, the Supplier will quote for the works.
- 6.2. The price of goods does not include installation which is always quoted separately on an ad hoc basis.
- 6.3. Installation services typically include the required tools but not any access equipment or MHE.
- 6.4. Installation is understood to happen in a safe clear environment provided by the Customer. This location must have clear access areas and no other contractors should be on site for the duration of the installation works.
- 6.5. The Supplier subcontracts installation works to experienced teams in the shopfitting sector.
- 6.6. The Customer is liable to check all mandatory H&S documentation for a safe proceeding of the works.

- 7. Title**
- 7.1. Title in the Goods supplied shall not pass to the Buyer until the Supplier has received full payment for those Goods.
- 7.2. If payment is not received, the Supplier reserves the right to arrange collection of the goods which may include labour costs. All costs will be charged to the Customer.

- 8. Customer's Obligations**
- 8.1. To enable the Supplier to perform its obligations under this Agreement the Customer shall:
- 8.1.1. Co-operate with the Supplier;
- 8.1.2. Provide the Supplier with any information reasonably required by the Supplier. This includes location specifics where there may be restrictions relating to size of vehicles, delivery times, parking and weight of goods.
- 8.1.3. Obtain all necessary permissions and consents which may be required before the commencement of the services;
- 8.1.4. In the case of sales where the Goods are to be delivered by the Supplier to the Buyer in a country outside the United Kingdom, the buyer must pay all additional charges or taxes necessary e.g. Goods and Service Tax etc. These additional charges or taxes are not the responsibility of the Supplier.
- 8.1.5. If goods are agreed to be held in stock by the Supplier, they must be dispatched by the agreed written date otherwise the goods will be invoiced and held in stock with a storage charge incurred, unless a further agreement is reached. This will most certainly apply if the product is a special item for the customer.
- 8.1.6. Comply with such other requirements as may be set out in the Order Acknowledgement or otherwise agreed between the parties.
- 8.2. The Customer shall be liable to compensate the Supplier for any expenses incurred by the Supplier as a result of the Customer's failure to comply with Clause 8.1.
- 8.3. Without prejudice to any other rights to which the Supplier may be entitled, in the event that the Customer unlawfully terminates or cancels the goods and services agreed to in the Order Acknowledgement, the Customer shall be required to pay to the Supplier as agreed damages and not as a penalty the full amount of any third party costs to which the Supplier has committed. For the avoidance of doubt, the Customer's failure to comply with any obligations under Clause 7.1 shall be deemed to be a cancellation of the goods and services and subject to the payment of the damages set out in this Clause.
- 8.4. In the event that the Customer or any third party, not being a sub-contractor of the Supplier, shall omit or commit anything which prevents or delays the Supplier from undertaking or complying with any of its obligations under this agreement, then the Supplier shall notify the Customer as soon as possible and:
- 8.4.1. The Supplier shall have no liability in respect of any delay to the completion of any project;
- 8.4.2. If applicable, the timetable for the project will be modified accordingly;
- 8.4.3. The Supplier shall notify the Customer at the same time if it intends to make any claim for additional costs.
- 8.5. Where installation services are to take place, it is the Buyers' responsibility to provide the following services at the Buyers' own cost and risk, and in good time to enable the Supplier to carry out the installation service:
- 8.5.1. Access to any relevant parts of the site;
- 8.5.2. Removal from the site of all Buyers' property not necessary for performance of the service;
- 8.5.3. Any scaffolding or plant equipment necessary for the work (unless it is otherwise agreed in writing that the Supplier will provide this);

- 9. Alterations to the order acknowledgement**
- 9.1. The parties may at any time mutually agree upon and execute new Order Acknowledgements. Any alterations in the scope of goods and/or services to be provided under this Agreement shall be set out in the Order Acknowledgement, which shall reflect the changed goods and/or services and any other price and any other terms agreed between the parties.
- 9.2. The Customer may at any time request alterations to the Order Acknowledgement by appealing directly to the Supplier. On request for alterations the Supplier shall supply and submit to the customer an amended Order Acknowledgement, showing altered goods and services and the effect of such alterations, if any, on the price and any other terms already agreed between the parties. Where the product has been ordered, manufactured and/or sprayed by the supplier, any changes to the specification after this time may be chargeable.

- 10. Warranties Concerning Description of Goods**
- 10.1. Except where the Supplier and the Buyer have otherwise expressly agreed in writing, the sale shall not be by samples submitted, descriptions, illustrations or forecasts in trade literature catalogues/brochures or otherwise howsoever shall be taken as showing type, class or general character only and not as importing terms or warranties as to substance, performance, colour, quality or dimension, and the failure to conform with such samples, descriptions or illustrations shall not constitute any breach of contract on the part of the Supplier.
- 10.2. Where a sample or samples have been provided to the Buyer to demonstrate their colour, the Buyer shall choose the colour that the Buyer wants by signing the colour sample label attached to the chosen sample, or its packaging, and returning the signed colour sample label to the Supplier. The Buyer shall not be entitled to reject Goods provided by the Supplier for any reason relating to the colour of the goods where the goods supplied are in conformity with the colour chosen by the Buyer as indicated by the colour sample label signed by the Buyer, and Delta E is <5.0.
- 10.3. Where a sample or samples have been provided to the Buyer for a specific new product designed for the customer, the buyer must provide a written purchase order to confirm the order. Where the product has begun manufacture upon receipt of purchase order, any changes to the specification after this time will be chargeable.

- 11. Product Warranty**
- 11.1. The Supplier guarantees products supplied for a maximum period of 12 months from the date of delivery where a fault is found due to quality, design or manufacture. This must be reported in writing to the Supplier within 12 months from date of delivery.
- 11.2. After investigation and should a fault be found, the Supplier will replace or repair the product within a timeframe which shall be notified to the customer by the supplier. This is on the provision that all weight loading capacities, maintenance and installation recommendations as stated in the Operations and Maintenance manual ref GO9 have been adhered to and that there has been no misuse of the product.
- 11.3. No indemnity or compensation of any kind can be claimed by the customer for the period of time in which it takes for the goods to be replaced or repaired.
- 11.4. The following is excluded from the Product warranty:
- 11.4.1. When installed without adhering to the Supplier's instructions or the expertise of a professional shopfitter/installer
- 11.4.2. Misuses when adjusting shelving (moving shelves around)
- 11.4.3. Misuse when the shelving has been in contact with cleaning machines or any other mechanical device
- 11.4.4. Misuses when the shelving has been stepped on by consumers or anyone in any way
- 11.4.5. Product exposed to the elements for whichever length of time
- 11.4.6. Product used below 5° Celsius or above 45° Celsius, any other practice which is not a typical indoor retailer's use of fixtures and outside of the Suppliers' operating manual
- 11.4.7. General wear and tear

- 12. Indemnification**
- 12.1. The Customer shall indemnify the Supplier against all claims, costs and expenses which the Supplier may incur and which arise, directly or indirectly, from the Customer's breach of any of its obligations under this Agreement, including any claims brought against the Supplier

- 13. Limitation of Liability**
- 13.1. Except in respect of death or personal injury due to negligence for which no limit applies, the entire liability of the Supplier to the Customer in respect of any claim whatsoever or breach of this Agreement, whether or not arising out of negligence, shall be limited to the price paid by the Customer to which the claim relates.
- 13.2. In no event shall the Supplier be liable to the Customer for any loss of business, loss of income, loss of opportunity or loss of profits or for any other indirect or consequential loss or damage whatsoever.
- 13.3. Nothing in these Terms and Conditions shall exclude or limit the Supplier's liability for death or personal injury resulting from the Supplier's negligence or that of its employees, agents or sub-contractors.

- 14. Termination**
- 14.1. Either party may terminate this Agreement forthwith by notice in writing to the other if the other party commits a material breach of this Agreement and, in the case of a breach capable of being remedied, fails to remedy it within 30 calendar days of being given written notice from the other party to do so;
- 14.2. All monies already due and to become due will remain due, including those for confirmed orders that the customer might not collect or authorise delivery of, and any worth amount at selling value for other stock commitment the customer has taken with the Supplier to facilitate what would have been future supplies;
- 14.3. The other party commits a material breach of this Agreement which cannot be remedied under any circumstances;
- 14.4. The other party passes a resolution for winding up (other than for the purpose of solvent amalgamation or reconstruction), or a court of competent jurisdiction makes an order to that effect;
- 14.5. The other party ceases to carry on its business or substantially the whole of its business; or
- 14.6. the other party is declared insolvent or convenes a meeting of or makes or proposes to make any arrangement or composition with its creditors; or a liquidator, receiver, administrative receiver, manager, trustee or similar officer is appointed over any of its assets.

- 15. Intellectual Property Rights**
- 15.1. The policy of the supplier is one of continuous technical improvement and the Supplier therefore reserves the right, from time to time, to review, modify or vary the technical specifications and designs of any Goods provided that the Goods as delivered shall be fit for purpose.
- 15.2. All designs, technical data, drawings, reports, documents, softwares and information in any form whatsoever (hardcopies, softcopies, 3D designs, samples, products) which the Supplier submits to the Buyer (and the copyright therein) shall remain the Suppliers' property, and must not be shown for the intention of copying or manufacturing elsewhere to any third party without the Supplier's express written consent being obtained in advance, and in any event upon the condition of a similar condition being imposed upon any third party.
- 15.3. So far as the supplier is aware, no Goods supplied by it infringe any existing patent or design or any other industrial or intellectual property rights, but no warranty express or implied is given in respect of such infringement of patents or other industrial or intellectual property rights by the use or sale of the Goods supplied hereunder. The Buyer shall notify the supplier immediately and the supplier may at its entire discretion and at its own expense conduct through its own lawyers and experts all negotiations and settlement of the sale or any litigation that may arise therefrom. If the buyer requested a specific product design to be manufactured by the supplier, or an existing product to be designed and/or improved by the supplier, the buyer would remain liable for any property rights infringements and will sustain all costs potentially incurred in (including but not limited to legal, reparations, damages costs) directly by the buyer and indirectly by the supplier by means of refund to the supplier.

- 16. Force Majeure**
- 16.1. Neither party shall be liable for any delay or failure to perform any of its obligations if the delay or failure results from events or circumstances outside its reasonable control, including but not limited to acts of God, strikes, lock outs, accidents, war, the act or omission of government, highway authorities or any telecommunications carrier, operator or administration or other competent authority, or the delay or failure in manufacture, production, or supply by third parties of equipment or services. The party shall be entitled to a reasonable extension of its obligations after notifying the other party of the nature and extent of such events.

- 17. Independent Contractors**
- 17.1. The Supplier and the Customer are contractors independent of each other, and neither has the authority to bind the other to any third party or act in any way as the representative of the other, unless otherwise expressly agreed to in writing by both parties. The Supplier may, in addition to its own employees, engage sub-contractors to provide all or part of the services being provided to the Customer and such engagement shall not relieve the Supplier of its obligations under this Agreement or any applicable Order Acknowledgement.
- 17.2. Nothing in this Agreement is intended to, nor shall it confer any rights on a third party.

- 18. Severability**
- 18.1. If any provision of this Agreement is held invalid, illegal or unenforceable for any reason by any Court of competent jurisdiction such provision shall be severed and the remainder of the provisions herein shall continue in full force and effect as if this Agreement had been agreed with the invalid illegal or unenforceable provision eliminated.

- 19. Waiver**
- 19.1. The failure by either party to enforce at any time or for any period any one or more of the Terms and Conditions herein shall not be a waiver of them or of the right at any time subsequently to enforce all Terms and Conditions of this Agreement
- 19.2. Any notice to be given by either party to the other may be served by email, personal service or by post to the address of the other party given in the here signed Terms and Conditions, or other address as such party may from time to time have communicated to the other in writing. And if sent by email shall unless the contrary is proved be deemed to be received on the day it was sent, if sent by fax shall be deemed to be served on receipt of an error free transmission report, if given by letter shall be deemed to have been served at the time at which the letter was delivered personally or if sent by post shall be deemed to have been delivered in the ordinary course of post.

- 20. Entire Agreements**
- 20.1. This Agreement contains the entire agreement between the parties relating to the subject matter and supersedes any previous agreements, arrangements, undertakings or proposals, oral or written. Unless expressly provided elsewhere in this Agreement, this Agreement may be varied only by a document signed by both parties.

- 21. Governing Law and Jurisdiction**
- 21.1. This Agreement shall be governed by and construed in accordance with the law of England & Wales and the parties hereby submit to the exclusive jurisdiction of the courts.

- 22. No Returns Policy**
- 22.1. The Supplier does not allow the Customer to return goods, unless under special circumstances and with written consent from a company authorised signatory. If the customer wishes to return goods to the Supplier, they should first contact the The Supplier department. The customer will need to detail the items to be returned, and the reason for the return. This needs to take place within 48 hours of the initial delivery date.
- 22.2. Each return will be assessed individually and a decision will be communicated to the Customer.
- 22.3. A return could be arranged if:-
- 22.3.1. All shipping costs to return the goods to the Supplier at Talke are paid for by the customer.
- 22.3.2. The goods are in immaculate condition – as they were when sent to the customer. A credit note will not be issued if the goods are returned in a poor condition.
- 22.3.3. The Customer is responsible for organising the safe packaging of returned goods. The goods should be packaged in the same way as they were when initially sent out by the Supplier. If goods are damaged due to incorrect packaging when returned to the Supplier, no credit note will be issued.
- 22.3.4. It will then be decided by the Supplier whether to issue a credit note, or to raise a purchase order to 'buy back' the stock. The value at which the Supplier will buy back will be at around 50% of original selling price.
- 22.3.5. For the avoidance of any doubt, without a written agreement from the Supplier, it is understood that the Customer remains liable to pay the full amounts as per confirmed orders of the returned goods.

- 23. Damaged goods**
- 23.1. Initially, if the packaging appears to be damaged on receipt of goods then the customer will need to write this clearly on the couriers/delivery companies' paperwork along with a signature at the time of receiving the goods. The damaged packaging will also need to be reported to the Supplier immediately. Failing to do so waives any right to damaged goods claims.
- 23.2. The Supplier will allow a 48-hour time frame (starting from the time of the initial delivery) for the Customer to check all goods received for damages. If goods received are in fact damaged (at the fault of the Supplier or our chosen delivery company), this should be notified to the Supplier within the 48-hour frame. The customer should first contact the Supplier and will need to provide full details of the damages (along with a DDT number to allow the order to be traced easily) along with photographs of the damaged goods.
- 23.3. The decision of the Supplier with regards to reported damaged goods will depend on whether it affects the aesthetics of the product(s) or the overall appearance of the store. The Supplier will decide to either:-
- 23.3.1. Request that the customer dispose of the damaged goods and the Supplier will raise a credit note to the customer's account.
- 23.3.2. Request that the customer dispose of the damaged goods and the Supplier will send out free of charge replacements for all damaged goods.
- 23.3.3. Arrange collection of the damaged goods from the customer's premises. Once the stock has been received and checked by the Supplier, a credit note will be raised or free of charge replacements will be sent out
- 23.3.4. Agree a discounted figure for the damaged goods rather than replacing or crediting - this will be authorised by the Managing Director.
- 23.3.5. Confirm that the Supplier is not responsible for the damaged goods, and they remain fully chargeable. The Supplier will endeavour to speed up the manufacturing of replacement goods that the Customer must order via another purchase order;

Please note – Any damages reported outside of the 48-hour time frame will not be considered for replacement or credit.

- 24. Shortages**
- 24.1. Any shortages should be notified to the Supplier within 48 hours of the initial delivery of the order. The customer should first contact the Supplier giving full details of the products(s) short delivered.
- 24.2. The Supplier will immediately endeavour to manufacture and deliver the goods claimed as short of. This is NOT an acceptance of responsibility and the Customer may still be charged for the goods and the delivery charges. This is done to expedite operations onsite.
- 24.3. The Supplier will then investigate the shortage and will decide either:-
- 24.3.1. It has not supplied short because all internal checks of paperwork and stock prove the goods have left (this happens typically when products are lost onsite or when the shopfit proceed with a layout revision different to the one used to quote for the shelving);
- 24.3.2. It has supplied short and once confirmed by the Supplier Operations Manager or Warehouse Team Leader that the shortage is due to an error by the Supplier, will then arrange for products to be sent as soon as possible after the shortage has been reported. Should the customer require an express delivery service, the customer will be responsible for any additional cost incurred, unless pre agreed by the Supplier in writing.
- 24.4. The Supplier remains not liable for any extra cost for onsite labour, extra fitting time, loss of revenue etc for the customer, third party or any other claims.

Please note – Any shortages reported outside of the 48-hour time frame will not be considered for credit or replacement.

These Terms and Conditions apply to every Order Confirmation/ Acknowledgement and Commitment taken to execute work and/or Services for the Customer

Internal Ref CAEM Terms and Conditions QF30 Rev 6 - July 2023.

Finally:

Stock availability and lead time varies.
Specifications can change at any time without notice.
Drawings within this catalogue are for illustration purposes only.
Colours are for illustration purposes only and my vary from those shown and between batches.



VERSATILITY

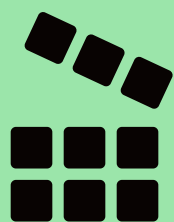

RESISTANCE

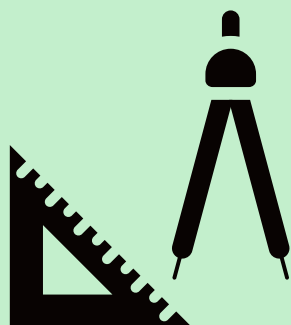
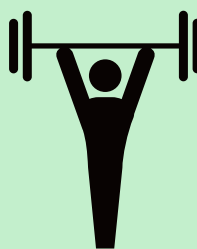

CUSTOM DESIGN



CUSTOMER CARE

Magrini (UK) Ltd
Unit 3 - Jamage Industrial Estate
Talke Pits - Stoke-On-Trent
ST7 1XW - UK

T. 01782 794500
information@caem.co.uk



This brochure is printed on
FSC® accredited paper from
sustainably managed forests.

Please ensure you recycle this at the
end of its life, by separating the metal
spine from the pages.

Document C20 Rev. 2. 202307

caem.co.uk/d25